



AIPAI App

Android Guide

Disclaimer:

This guide has been created for educational purposes only and in an effort to help the reefing community.

It is not intended to address specific issues or replace the official owner's manual for any product.

The information provided is for general guidance and should not be considered as a substitute for professional advice or manufacturer's instructions.

This is not a complete guide on how to use the AIPAI app. It is based solely on my personal experience, and I do not claim to be an expert on it. Certain features of the app have not been tested and are therefore not included in this guide.

Use this guide at your own discretion and risk. You are solely responsible for any damage to any of equipment or devices due to the use or misuse of this guide.

I am not affiliated with, endorsed by, or in any way connected to the product vendor or manufacturer mentioned herein. The content provided is distributed freely, without any monetary gain or commercial interest.

All copyright images, trademarks, and product names mentioned or used in this guide are the property of their respective owners. All rights are reserved by the respective copyright holders.

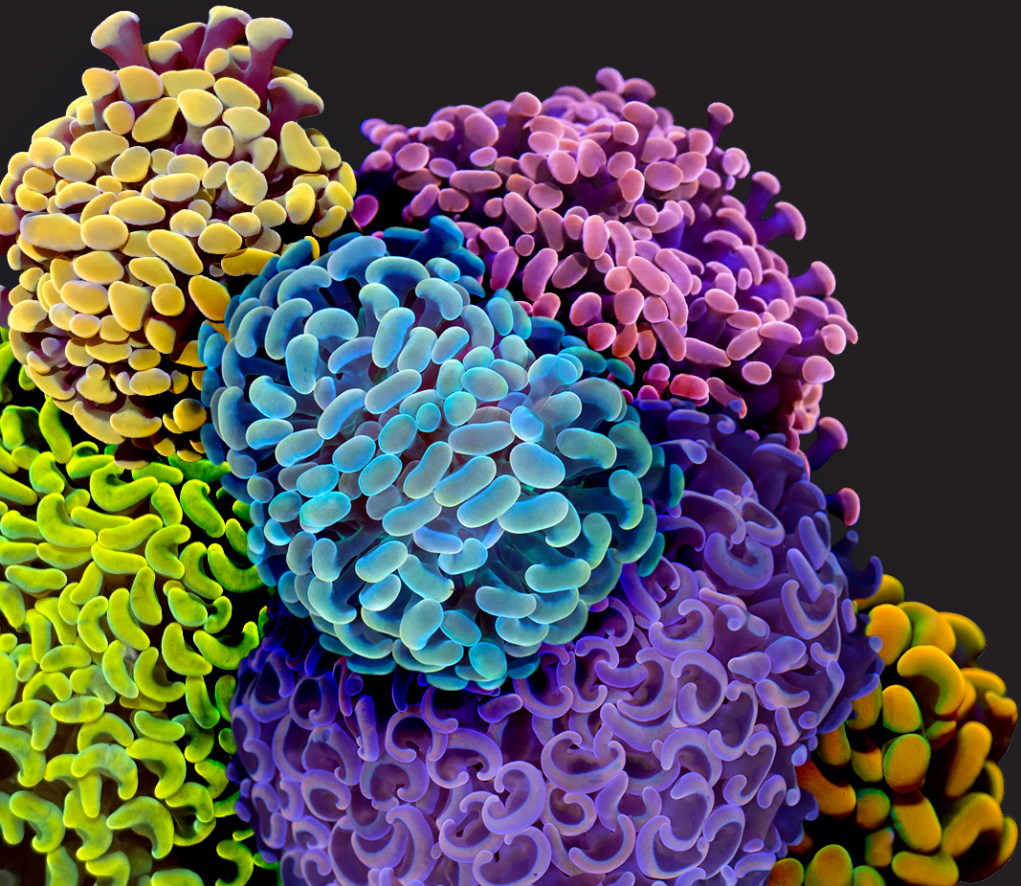

A8 PRO II LED distribution

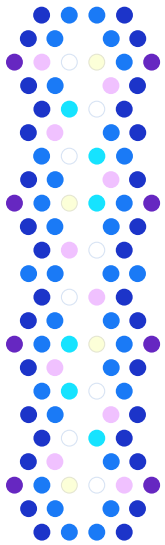

- 8 × Cool White
- 32 × Royal Blue
- 32 × Blue
- 6 × Sky Blue
- 4 × Warm White
- 4 × 395nm UV
- 2 × 405nm UV
- 4 × 415nm UV
- 8 × 430nm UV

BEFORE WE BEGIN:

This guide has been created using a Samsung phone running Android version 13. However, since all Android phones share a similar operating system, you should be able to follow these steps (or similar ones) on most Android devices to install and connect to the A8 Reef Light.

For specific information about your phone's functionalities, please consult your phone's user or owner's manual.

The light we'll be connecting today is the A8 PRO II. However, there are different versions and generations of the A8 Reef Light (A8 SE, A8 SE II, A8 PRO, and A8 PRO II). That said, the connection steps should be similar.

For specific information about each light, please visit the vendor's website.

Installation Steps

Download the App

Download the app using the QR code in the product manual provided inside the box of the product provided by the vendor.

Installing the App

Once the app has been downloaded, you may run into two different issues while trying to install it:

Issue #1: *The app cannot be installed because it doesn't meet Google security requirements.*

When you first try to install the app, you might receive the message above or a similar message stating that the app cannot be installed because it doesn't meet Google's security requirements or standards. Since this requires modifying the security settings on your device, once completed, please revert the steps to secure your phone again. **These steps can be done before before downloading the app.** Here's the solution:

1. In your phone go to **Settings > Apps**
2. Tap in the 3 Dots Menu in the top right hand side and then tap **Special access**.

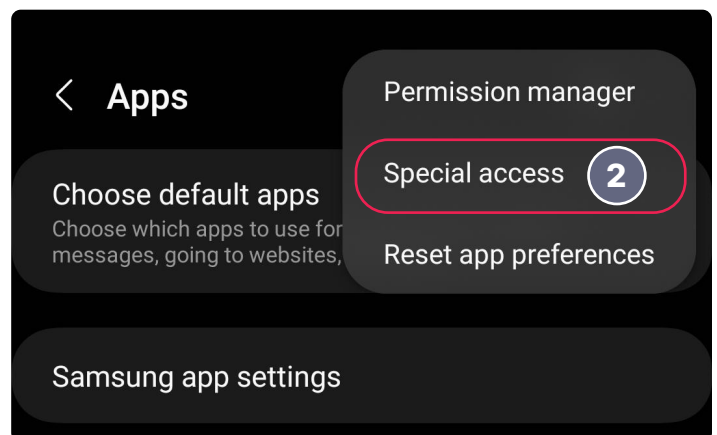
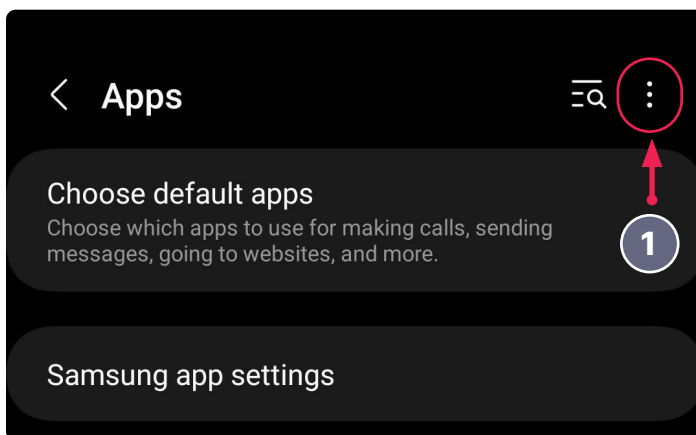

3. Once you're on the Special access screen, tap on the option to Install unknown apps.
4. In the Install unknown apps section, enable the apps from which you will trigger the installation. In my case, I enabled Samsung Internet and My Files, which is where the app will be saved after it has been downloaded.

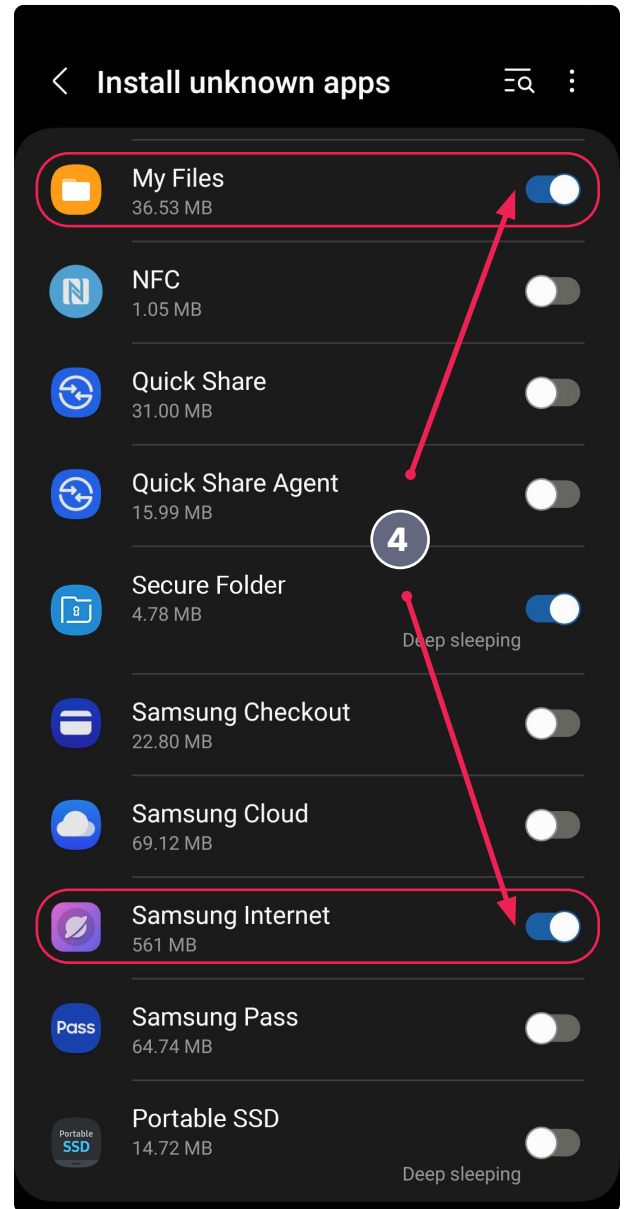
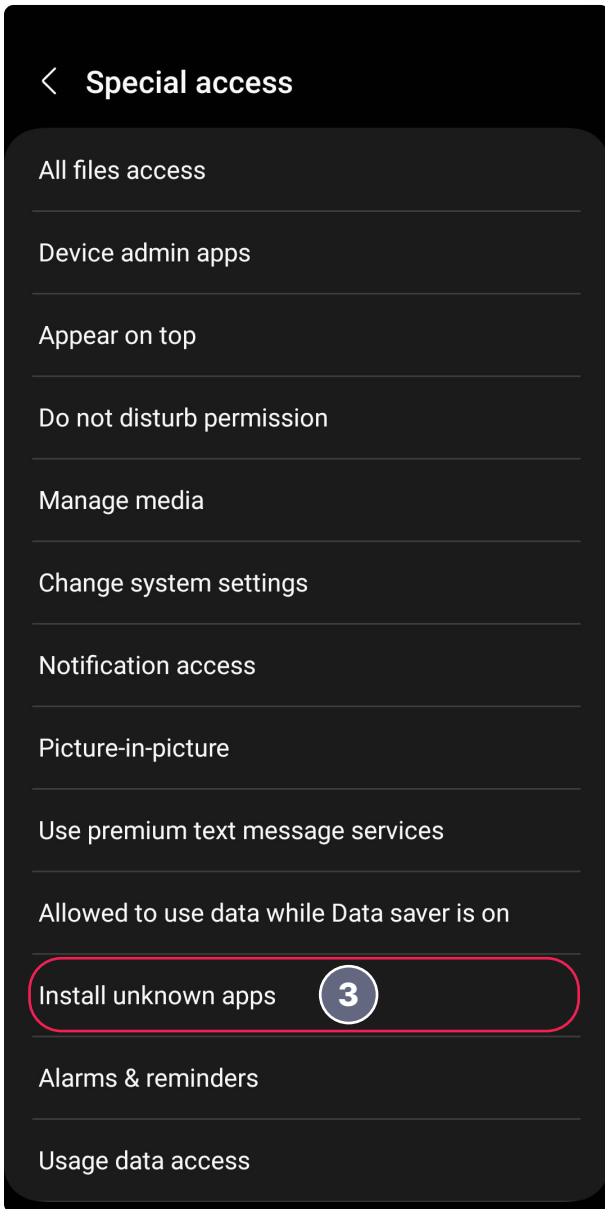

Once you have enabled the ability to install unknown apps on your device, you might run into a second issue, which is that the app was built for older devices. We will address that issue next.

Issue #2: Unsafe app blocked. This app was built for an older version of Android...

This second issue may be partially resolved if you completed the previous steps; however, you might still encounter the issue that this app was not built for your version of Android. Here's the solution:

1. When the **Unsafe app blocked** message shows, tap on the **More details** option.
2. Tap in the option **Install anyway**, and the application should be installed on your device successfully.

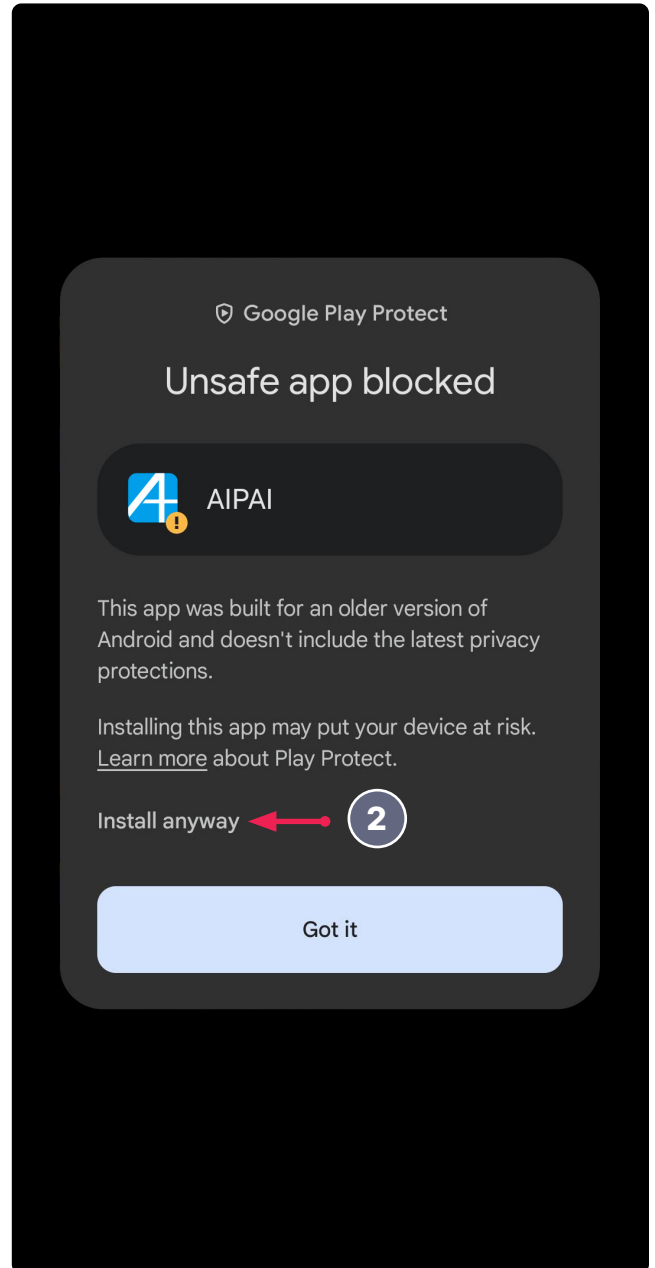
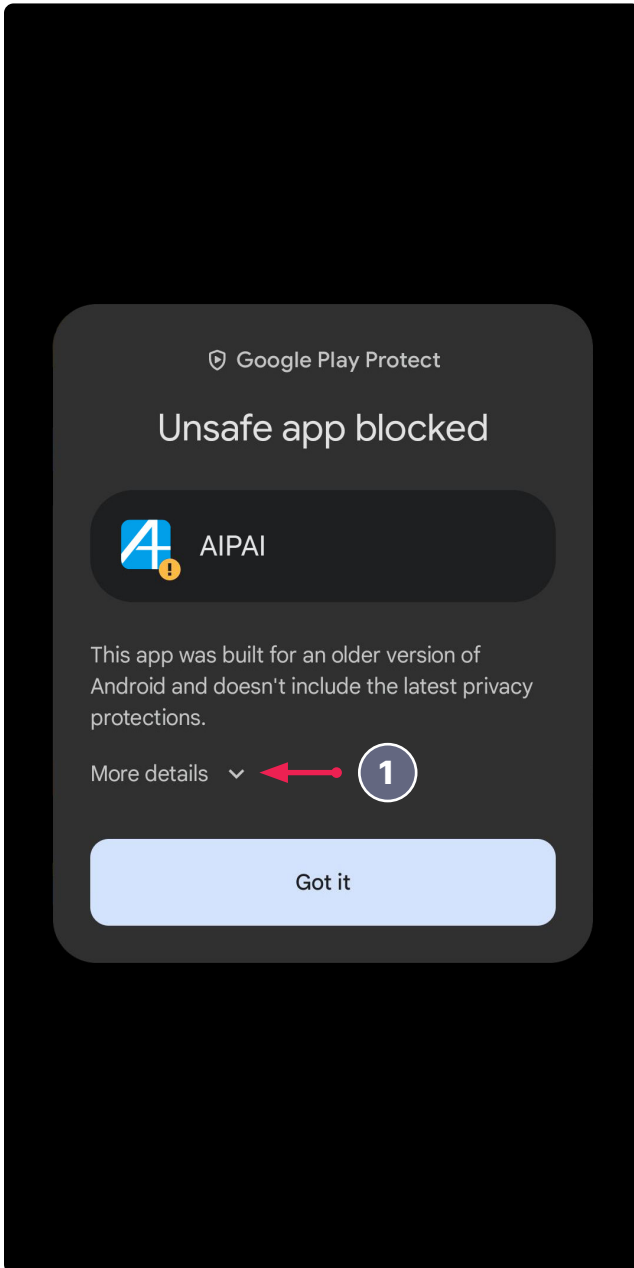

Adding the Lights to the App Using Wi-Fi

BEFORE WE BEGIN:

The A8 lights use the 2.4 GHz Wi-Fi radio frequency band for wireless communication to connect with your router or modem. If your modem or router doesn't support that frequency and only has 5 GHz, you will not be able to connect to your lights.

Connecting and adding the light to the app

Download the app using the QR code found in the product manual included inside the box. The app is available for both iPhone and Android devices.

1. Before adding the lights, it is highly recommended to set the correct time zone in the app settings. This ensures the lights are configured properly. So, before we begin, open the **AIPAI** app, tap the **My** icon at the bottom, and then select **TimeZone**, and finally select your time zone. In this case I have selected **UTC-05:00**, which correspond to **Eastern Standard Time**, which during Daylight Saving Time it would be **UTC-04:00**.

It's important to note that the app does not recognize Daylight Saving Time. As a result, depending on the time of year, the time on the lights may be off by one hour. You can adjust your settings accordingly, if desired. To determine your correct UTC time zone in the U.S., visit <https://www.time.gov>.

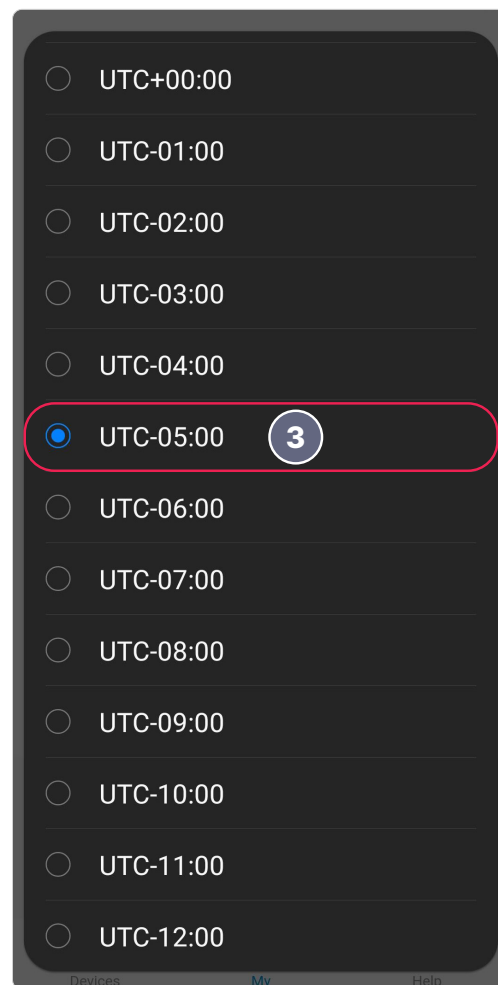
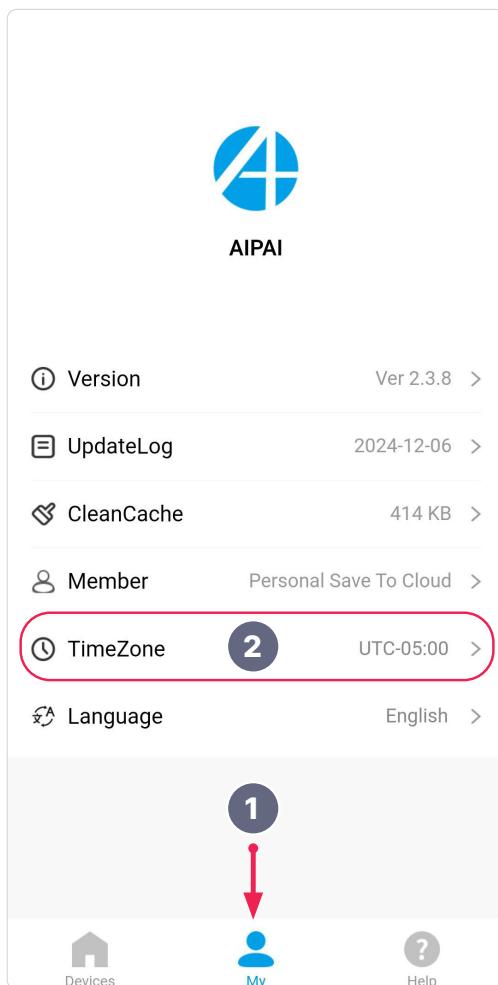

Connecting and Adding the Light

When the lights turn on, they will go through a series of tests to check each individual LED channel/color. Once the test is complete, the lights will remain on without changing colors.

Now that we've configured the ⌚ **TimeZone** setting in the app and the light(s) are on, it's time to link the light(s) to the app.

1. Open the app and tap the **Add New Device** button (+) in the top right-hand corner.

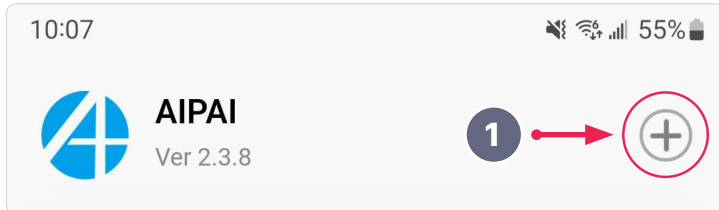

2. The next screen will prompt you to open your phone's **Wi-Fi** settings. Next, without closing the app, go to your phone's **Wi-Fi** settings and select the light from the list of **Available networks**, and your phone will connect to the light via Wi-Fi. Note that the light's network name starts with **ALight**, followed by a series of numbers.

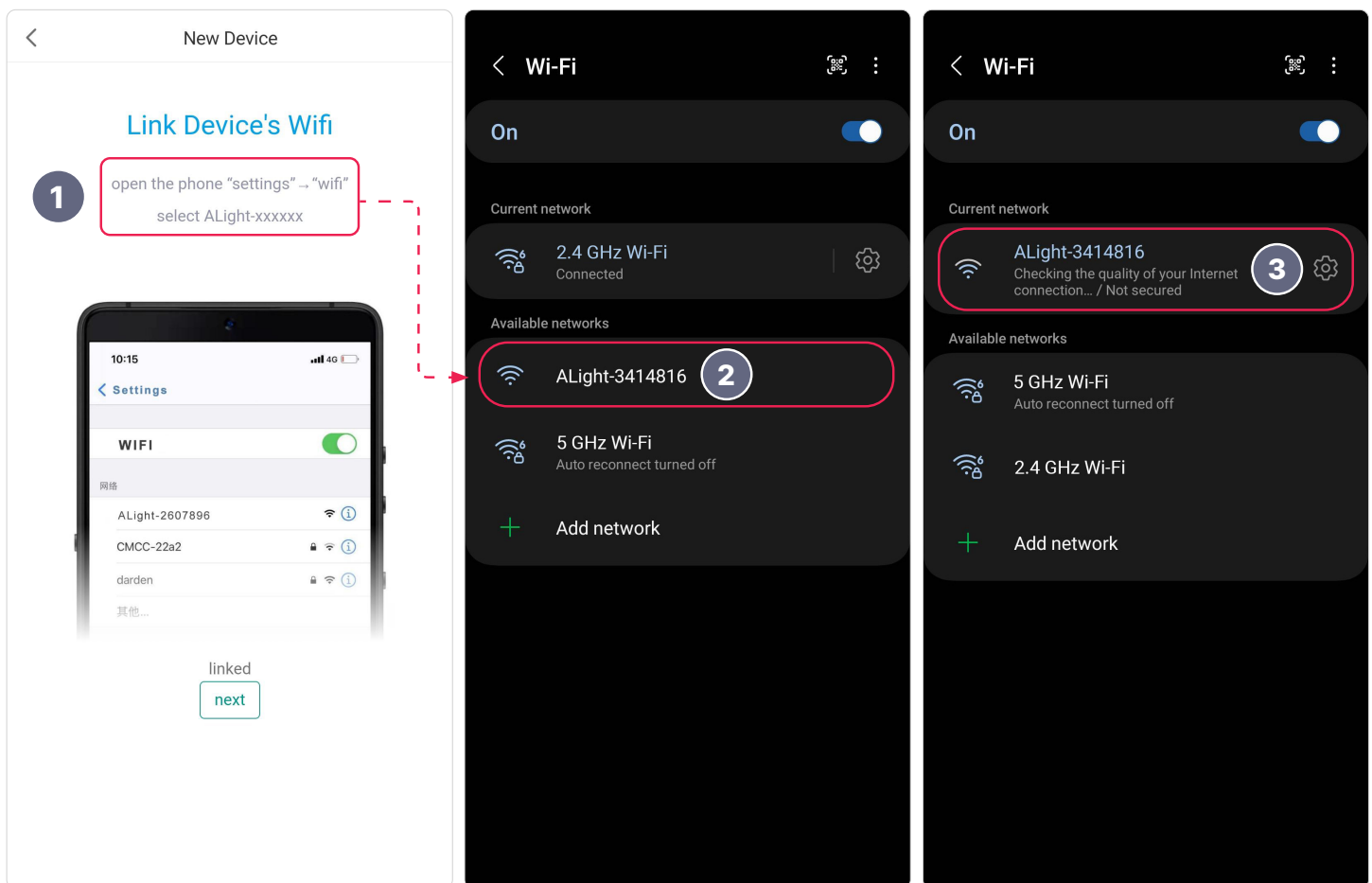

- Now, return to the **AIPAI** app. A new dialog will appear asking if you want to direct link to the current device. Tap the **No** button and then tap **Next**.
- On the next screen, you'll see a **scan...** box message indicating that the app is attempting to connect to your 2.4 GHz Wi-Fi network. Once the scan is complete, enter your Wi-Fi network password in the **type in the password** input field, and tap the **Link** button to finalize the connection. Note that the **Link** button will turn blue after you enter your password.

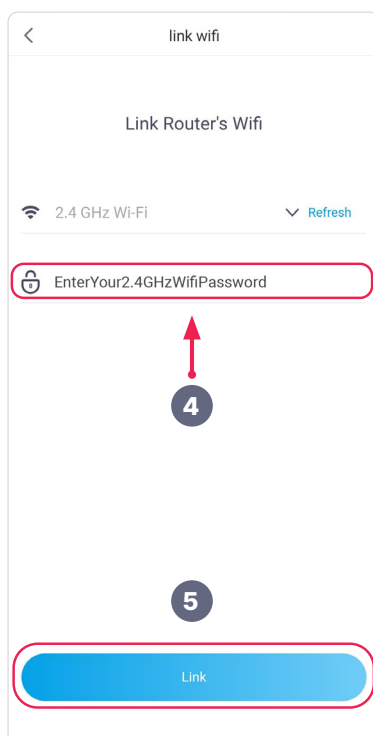
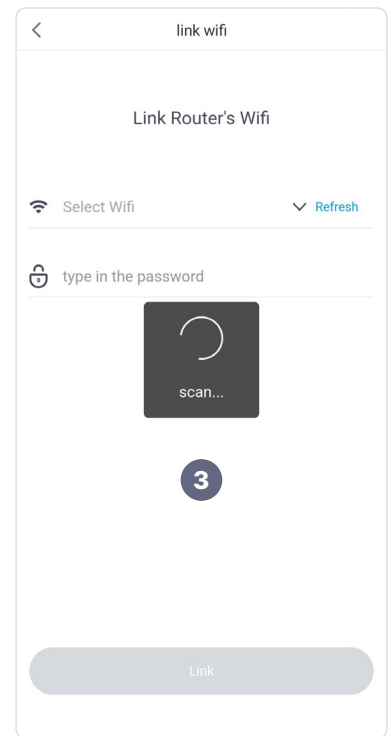
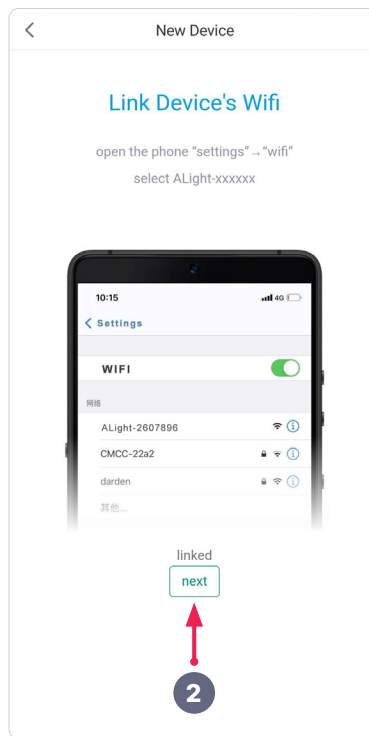
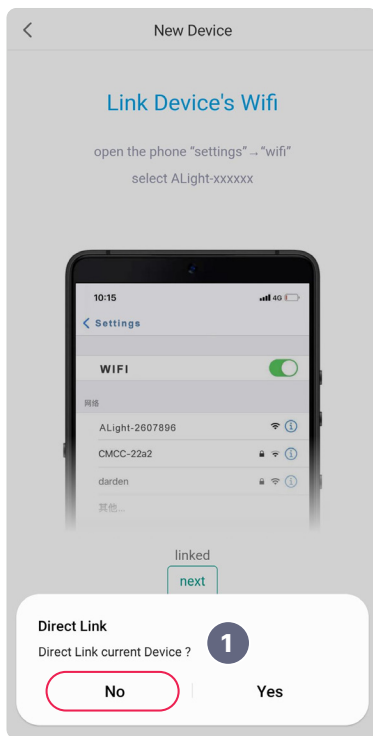

TIP

If you don't see your light listed under the **Available networks**, press and hold the **Reset** button on your light for about 5 seconds and let go. The light will reset and go through the testing process again. Once the reset is complete, try connecting and adding the light by following the previous steps.



- Now that the light is connected, enter a **Name** for your light and a **Group** name. Note: the group name **All** is available by default in the app.
- Finally, tap the **Save** button to save your light. Your light is now ready to be controlled and configured through the app.
- After saving the light, the app will ask you to reconnect to your 2.4 GHz Wi-Fi network to control the light. If your 2.4 GHz Wi-Fi network is set as your default, this will happen automatically. If not, tap the **Set WIFI** button to open your device's Wi-Fi settings and reconnect to your network. Then return to the AIPAI app to configure your light schedule.
- Now, the light should appear on the **Devices** screen, ready for you to configure. If for any reason you need to edit or delete your light, you can do so by tapping the **Edit** button.

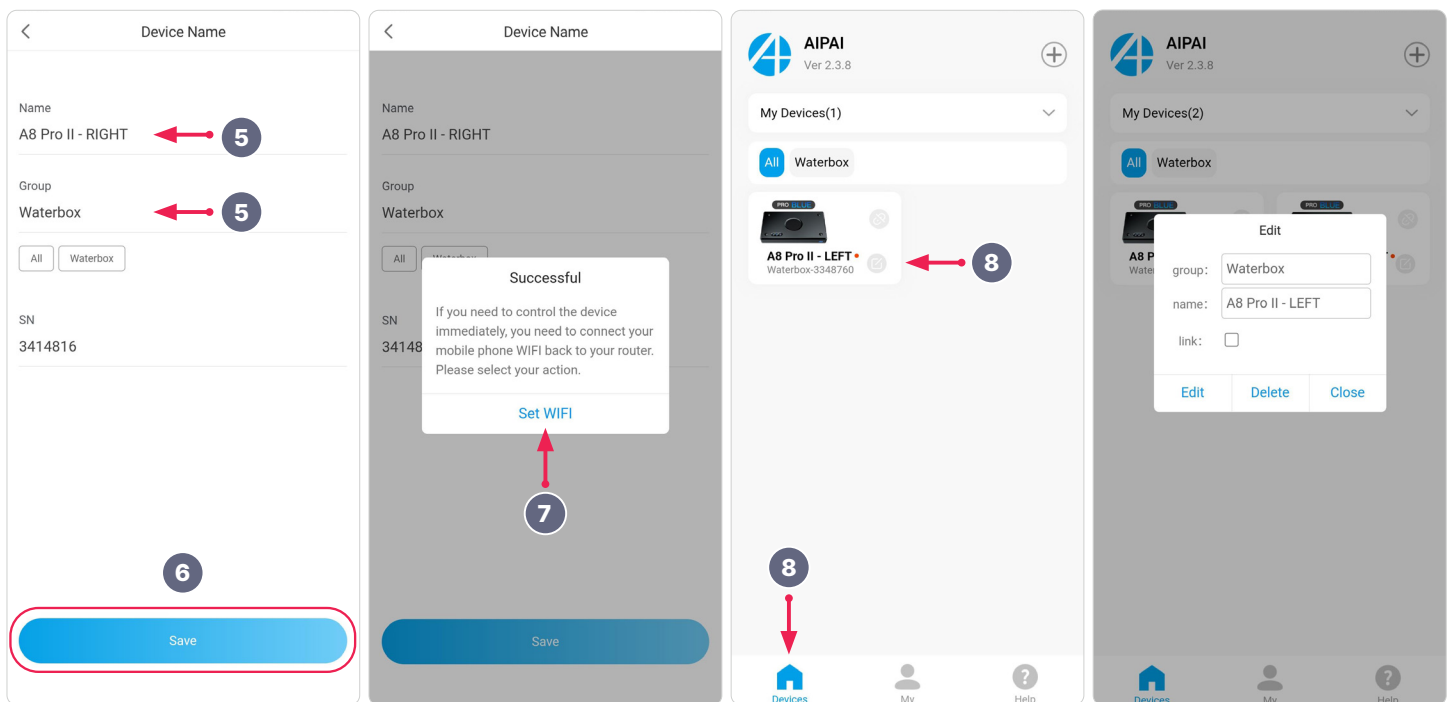

- Additionally if you multiple lights you can link them together using the link buttons.

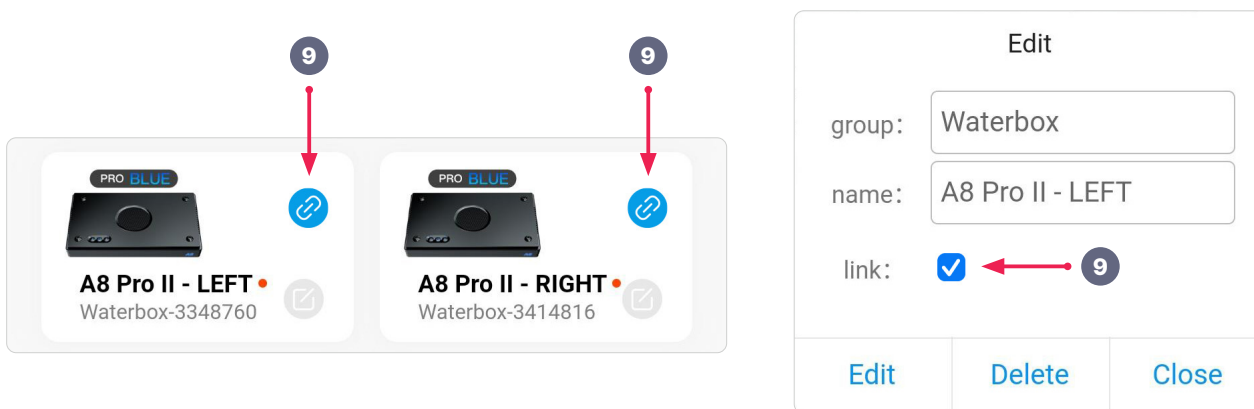

- To edit your light schedule, simply tap on the picture of the light to access its settings.

Configuring Your Light

The following section will explain some of the functionalities of the buttons. It won't go into great depth about each button, but it should provide enough information to get you started and help you configure your light.



SYNCING LIGHT TIME AND APP TIMEZONE:

1. When you first enter your light settings, you will be prompted to correct the time on the device. Tap the **ok** button and wait for the process to complete. Once finished, the time displayed above the light will be set correctly based on the **TimeZone** previously set in the app.
2. At that point, tap the  **Save Device** button to save and set the correct time on your light.

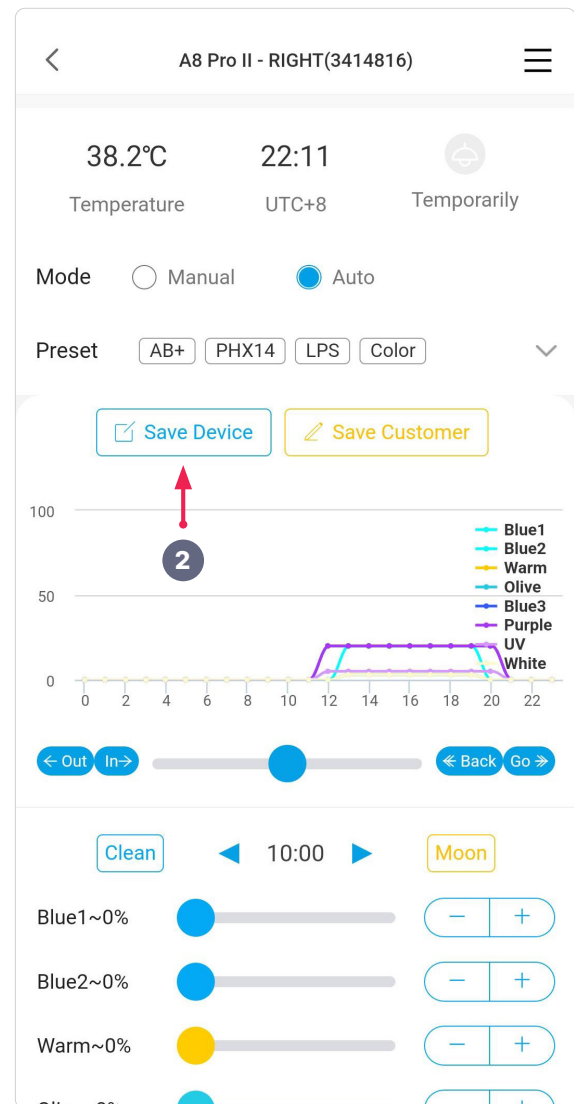
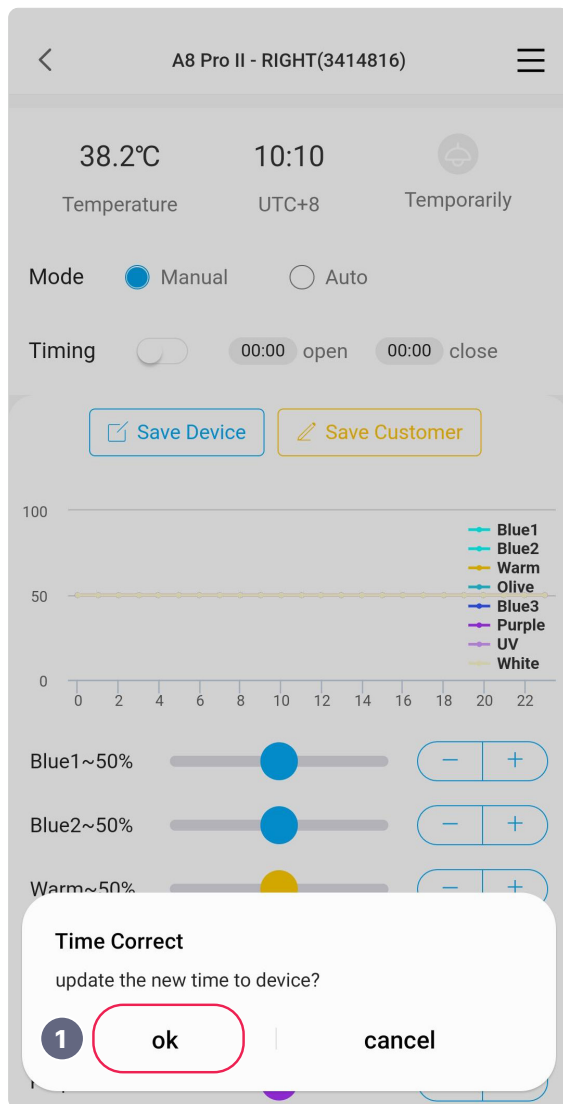
Note: When accessing the light settings in the future, you might be prompted to update the time on your device again. However, this may not be necessary, and you can simply tap the **cancel** button to ignore this message.



App Button Functions

- 1 **Mode**
 Manual: Set a manual configuration
 Auto: Set an automatic Light Schedule
- 2 **Preset**
 Select your Light preset. You can select from the provided presets in the app or your previously saved presets.
- 3 **Save Device**
 Save your settings to the Light.
- 4 **Save Customer**
 Saves your current Light Preset.
- 5
Moves the left side of the graph left or right to increase or decrease the time your lights will be on or off.
- 6 
Light Intensity Slider: Press and hold, then drag left or right to increase or decrease the overall intensity of the schedule. The slider may not respond smoothly, so manual fine-tuning might be required using the individual light settings.
- 7
Moves the entire graph left and right to change the start and end time of your light schedule.
- 8
WARNING: This will delete your entire light schedule.
- 9
 Move back and forth in one-hour intervals, allowing you to adjust the light colors and intensity for each hour.
- 10
 No Tested.
- 11 **Blue1~0%**
 Displays the current light color and light intensity percentage.
- 12 
Single Light Intensity Slider: Press and hold, then drag left or right to adjust the intensity of the selected LED color.

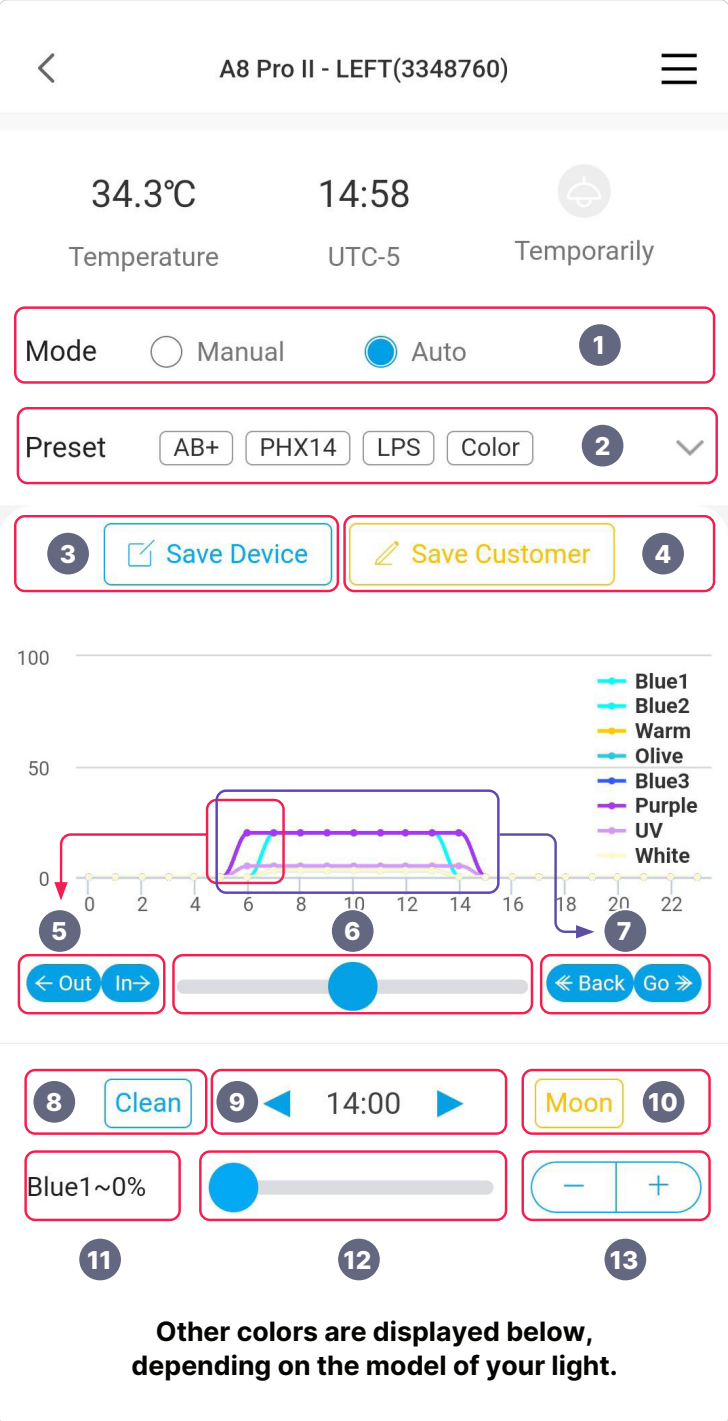

Other colors are displayed below, depending on the model of your light.

- 13
Plus/Minus Buttons: Tap to increase or decrease the intensity of the selected LED color.

Other Settings

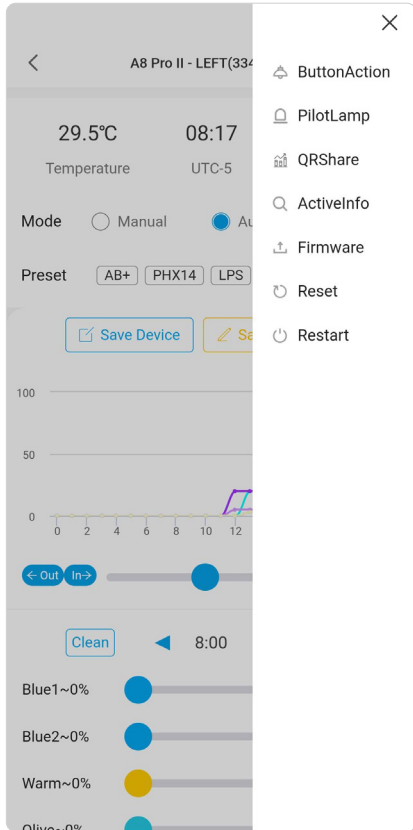

Light Settings (The following options have not been tested)

Although the functionality of certain buttons within the **Light Settings** section appears to be self-explanatory, it is important to note that I did not have the opportunity to test them at the time this guide was created; therefore, they have not been included or explained.

 **ButtonAction**

 **PilotLamp**

 **QRShare**

 **ActiveInfo**

 **Firmware**

 **Reset**

 **Restart**

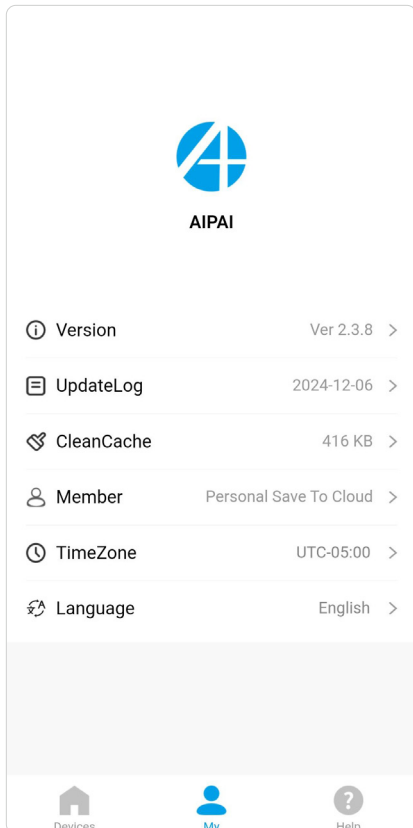

App Settings

 **Version**
Displays the current version of the app.

 **UpdateLog**
Displays the date and changelog for the application update (Chinese only).

 **ClearCache**
Clears the application cache.

 **Member**
Not Tested.

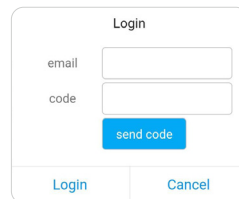

 **TimeZone**
Provides an option to select the appropriate app time zone.

 **Language**
Provides an option to select the app language.
Available options: English and Chinese.

 **Help (Bottom Navigation Menu)**
Displays a brief guide with screenshots on how to link multiple devices.

Thanks

I hope this guide—though not comprehensive—offers some helpful direction in connecting and setting up your A8 Light. Enjoy, and happy reefing!

