



# AIPAI App

## Android Guide

### DISCLAIMER:

This guide has been created for **educational and informational purposes only** and in an effort to help the reefing community.

It is not intended to address specific issues or replace the official owner's manual for any product.

The information provided in it is for general guidance and should not be considered as a substitute for professional advice or manufacturer's instructions.

This is not a complete guide on how to use the AIPAI app. It is based solely on my personal experience, and I do not claim to be an expert on it. Certain features of the app have not been tested and are therefore not included in this guide.

Use this guide at your own discretion and risk. You are solely responsible for any damage to any of equipment or devices due to the use or misuse of this guide.

I am not affiliated with, endorsed by, or in any way connected to the product vendor or manufacturer mentioned herein. The content provided is distributed freely, without any monetary gain or commercial interest.

All copyright images, trademarks, and product names mentioned or used in this guide are the property of their respective owners. All rights are reserved by the respective copyright holders.

### COPYRIGHT AND IMAGE USE

ALL TRADEMARKS, LOGOS, PRODUCT NAMES, AND COPYRIGHTED MATERIALS MENTIONED OR USED IN THIS GUIDE ARE THE PROPERTY OF THEIR RESPECTIVE OWNERS. NO COPYRIGHT INFRINGEMENT IS INTENDED. TREATED IMAGES OF CORALS AND OTHER MATERIALS USED HEREIN ARE BASED ON WORKS CREATED BY THIRD PARTIES AND EDITED USING AN IMAGE EDITING SOFTWARE. I DO NOT CLAIM OWNERSHIP OF THESE ORIGINAL WORKS.

If you are a copyright holder and believe that your image or content has been used improperly, please contact me, and I will promptly remove it upon request.

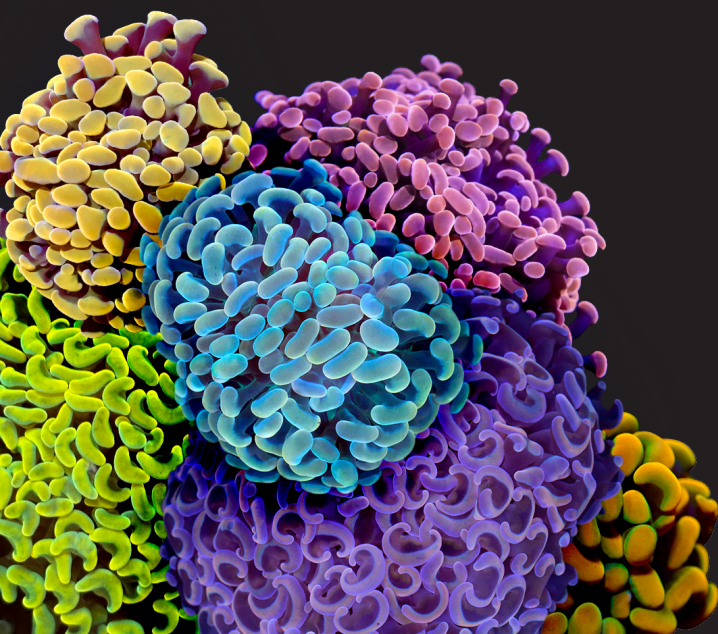

**Version v2.3.8 - v2.3.26**

Page 1 - 10



**Version v3.0.3 - v3.0.7**

Page 12 - 17

## A8 PRO II LED distribution

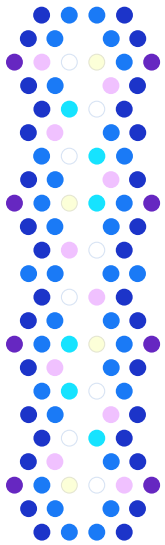

- 8 × Cool White
- 32 × Royal Blue
- 32 × Blue
- 6 × Sky Blue
- 4 × Warm White
- 4 × 395nm UV
- 2 × 405nm UV
- 4 × 415nm UV
- 8 × 430nm UV

## BEFORE WE BEGIN:

This guide has been created using a Samsung phone running Android version 13. However, since all Android phones share a similar operating system, you should be able to follow these steps (or similar ones) on most Android devices to install and connect to the A8 Reef Light.

For specific information about your phone's functionalities, please consult your phone's user or owner's manual.

The light we'll be connecting today is the A8 PRO II. However, there are different versions and generations of the A8 Reef Light (A8 SE, A8 SE II, A8 PRO, and A8 PRO II). That said, the connection steps should be similar.

For specific information about each light, please visit the vendor's website.

# Installation Steps

## Download the App

Download the app using the QR code in the product manual provided inside the box of the product provided by the vendor.

## Installing the App

Once the app has been downloaded, you may run into two different issues while trying to install it:

### Issue #1: *The app cannot be installed because it doesn't meet Google security requirements.*

When you first try to install the app, you might receive the message above or a similar message stating that the app cannot be installed because it doesn't meet Google's security requirements or standards. Since this requires modifying the security settings on your device, once completed, please revert the steps to secure your phone again. **These steps can be done before before downloading the app.** Here's the solution:

1. In your phone go to **Settings > Apps**
2. Tap in the 3 Dots Menu in the top right hand side and then tap **Special access**.

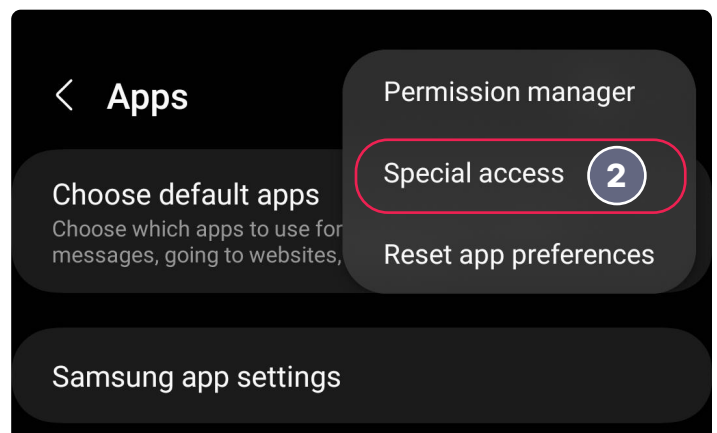
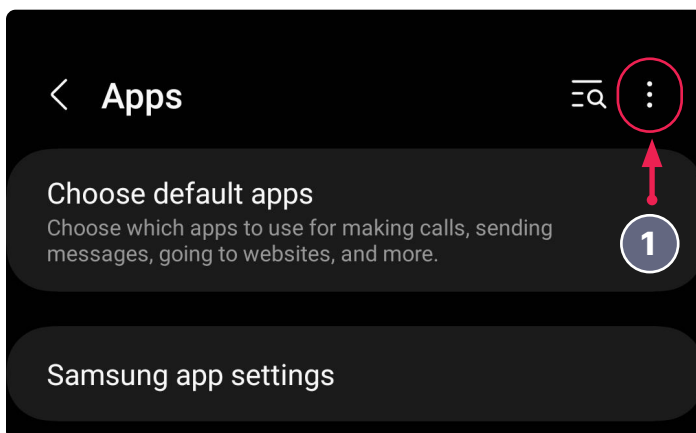

3. Once you're on the Special access screen, tap on the option to Install unknown apps.
4. In the Install unknown apps section, enable the apps from which you will trigger the installation. In my case, I enabled Samsung Internet and My Files, which is where the app will be saved after it has been downloaded.

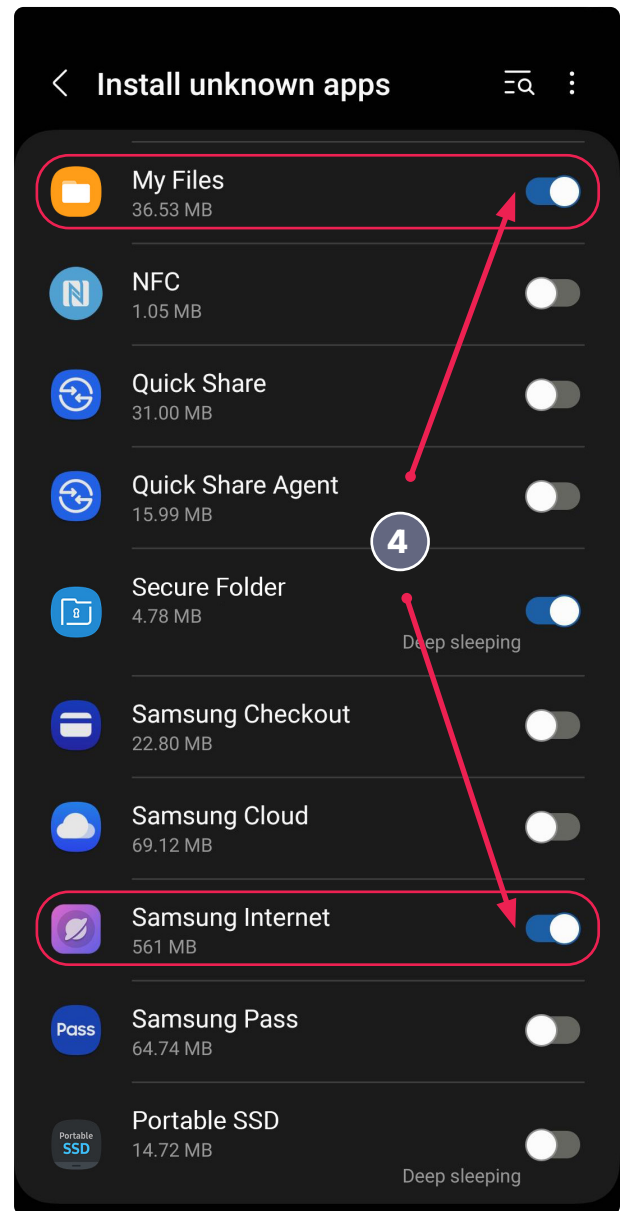
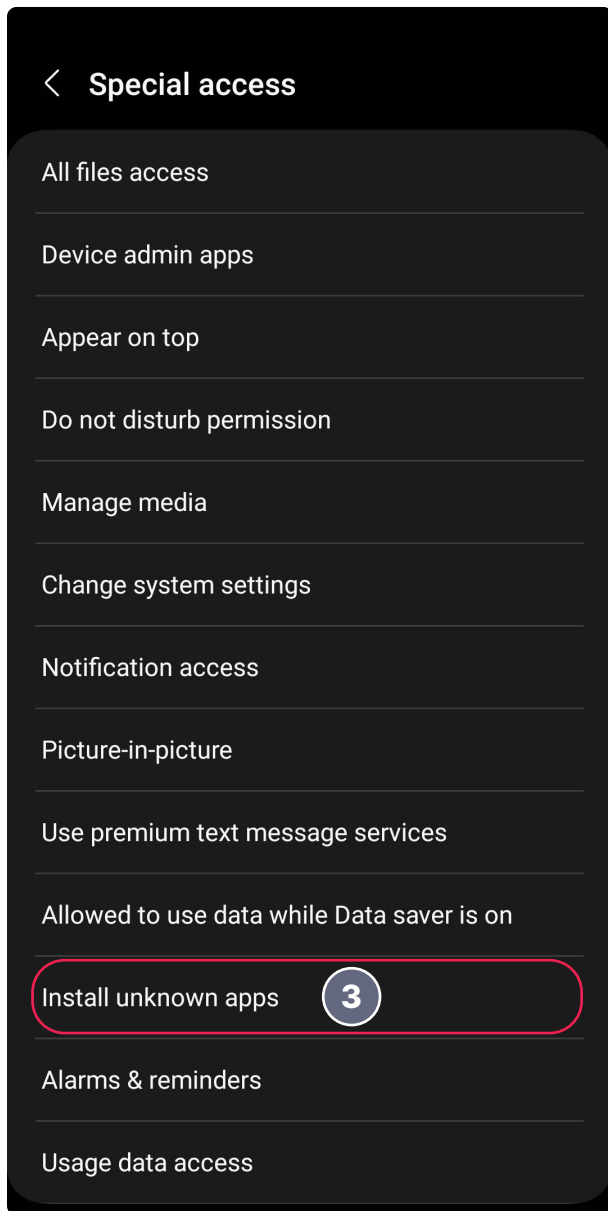

Once you have enabled the ability to install unknown apps on your device, you might run into a second issue, which is that the app was built for older devices. We will address that issue next.

**Issue #2: Unsafe app blocked. This app was built for an older version of Android...**

This second issue may be partially resolved if you completed the previous steps; however, you might still encounter the issue that this app was not built for your version of Android. Here's the solution:

1. When the **Unsafe app blocked** message shows, tap on the **More details** option.
2. Tap in the option **Install anyway**, and the application should be installed on your device successfully.

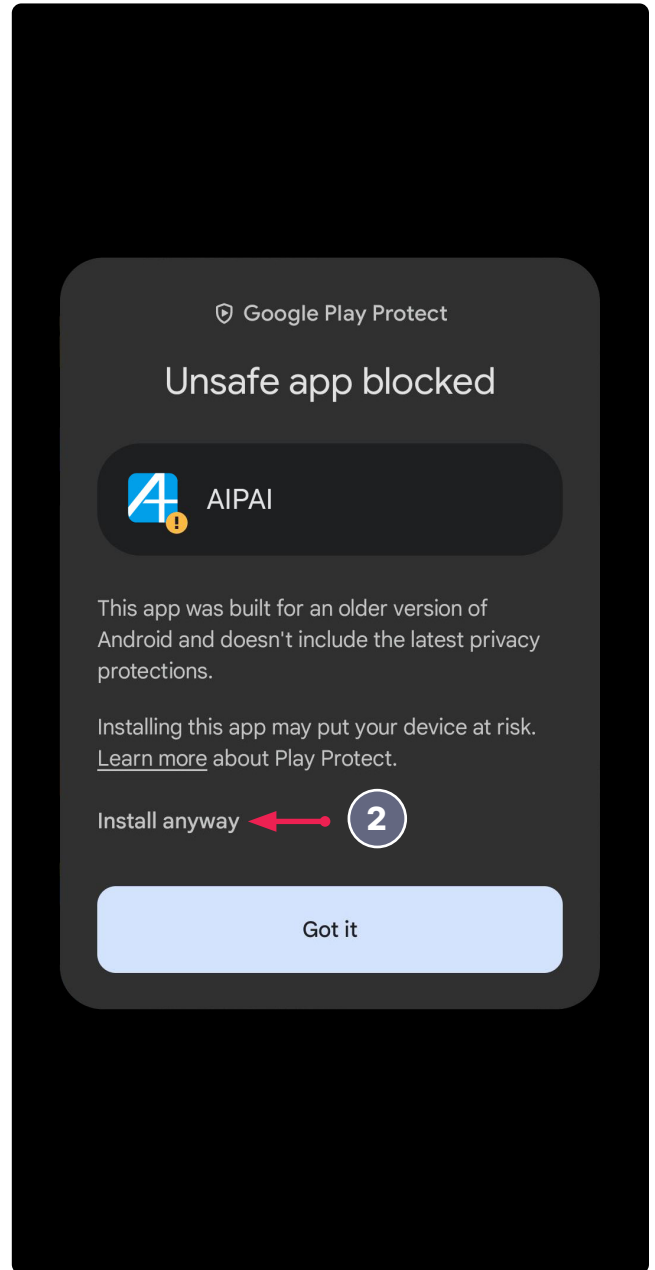
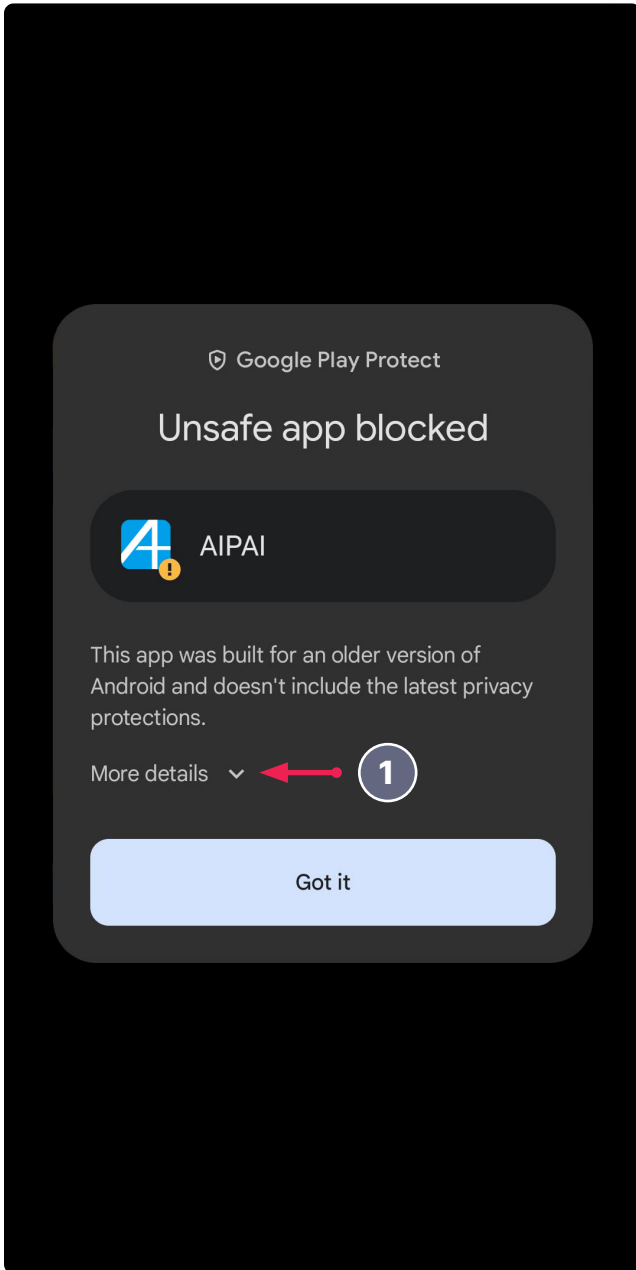

# Adding the Lights to the App Using Wi-Fi

## BEFORE WE BEGIN:

The A8 lights use the 2.4 GHz Wi-Fi radio frequency band for wireless communication to connect with your router or modem. If your modem or router doesn't support that frequency and only has 5 GHz, you will not be able to connect to your lights.

## Connecting and adding the light to the app

Download the app using the QR code found in the product manual included inside the box. The app is available for both iPhone and Android devices.

1. Before adding the lights, it is highly recommended to set the correct time zone in the app settings. This ensures the lights are configured properly. So, before we begin, open the **AIPAI** app, tap the **My** icon at the bottom, and then select **TimeZone**, and finally select your time zone. In this case I have selected **UTC-05:00**, which correspond to **Eastern Standard Time**, which during Daylight Saving Time it would be **UTC-04:00**.

It's important to note that the app does not recognize Daylight Saving Time. As a result, depending on the time of year, the time on the lights may be off by one hour. You can adjust your settings accordingly, if desired. To determine your correct UTC time zone in the U.S., visit <https://www.time.gov>.

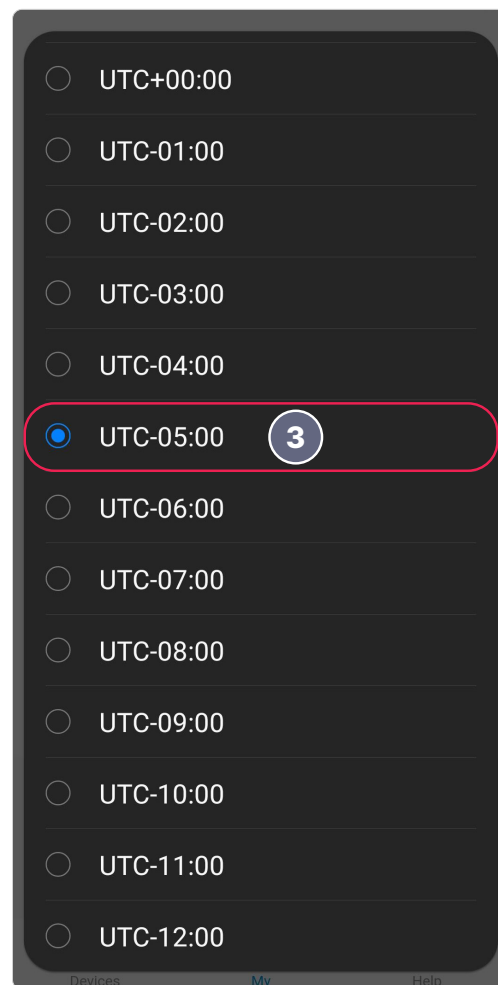
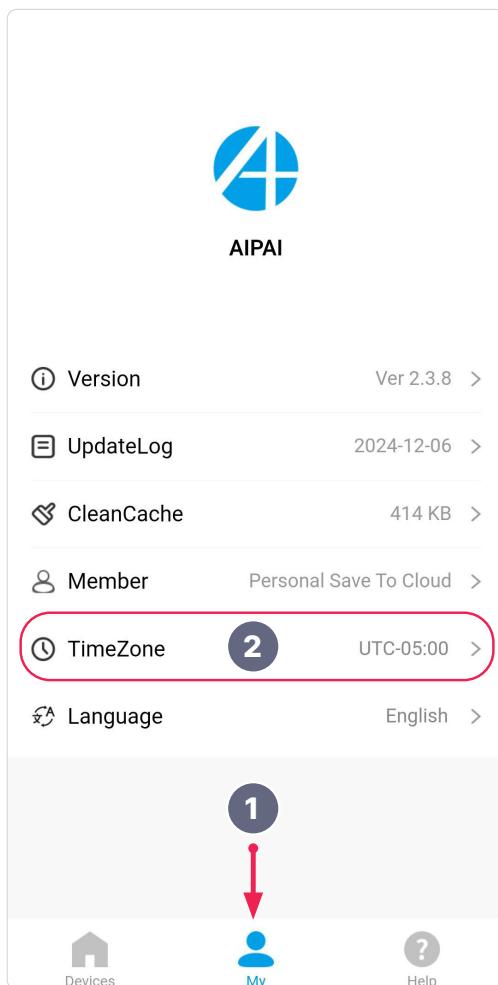

# Connecting and Adding the Light

When the lights turn on, they will go through a series of tests to check each individual LED channel/color. Once the test is complete, the lights will remain on without changing colors.

Now that we've configured the ⌚ **TimeZone** setting in the app and the light(s) are on, it's time to link the light(s) to the app.

1. Open the app and tap the **Add New Device** button (+) in the top right-hand corner.

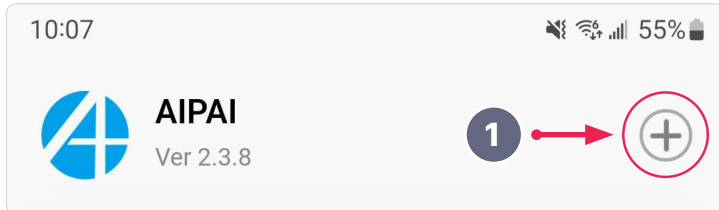

2. The next screen will prompt you to open your phone's **Wi-Fi** settings. Next, without closing the app, go to your phone's **Wi-Fi** settings and select the light from the list of **Available networks**, and your phone will connect to the light via Wi-Fi. Note that the light's network name starts with **ALight**, followed by a series of numbers.

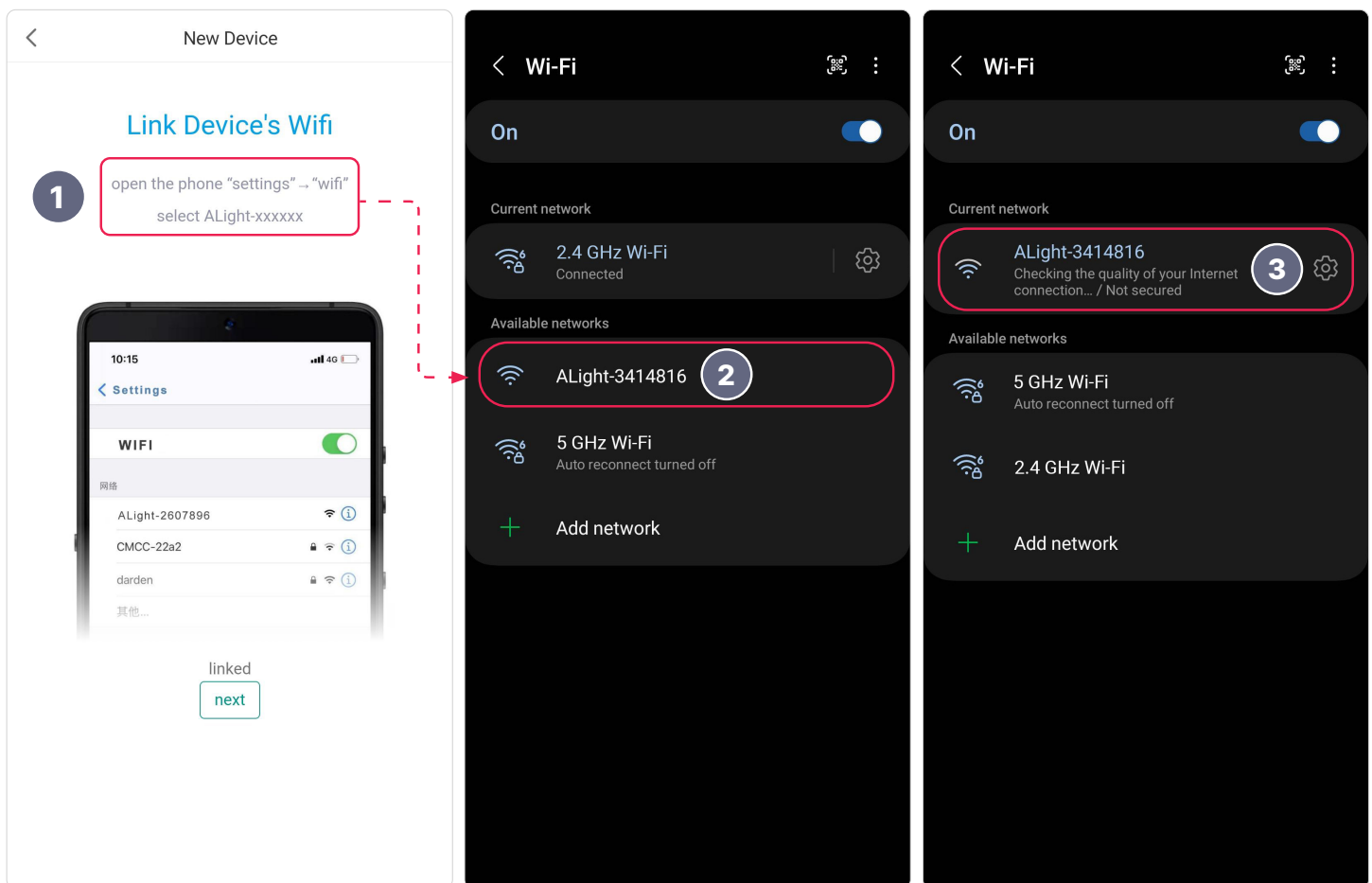

- Now, return to the **AIPAI** app. A new dialog will appear asking if you want to direct link to the current device. Tap the **No** button and then tap **Next**.
- On the next screen, you'll see a **scan...** box message indicating that the app is attempting to connect to your 2.4 GHz Wi-Fi network. Once the scan is complete, enter your Wi-Fi network password in the **type in the password** input field, and tap the **Link** button to finalize the connection. Note that the **Link** button will turn blue after you enter your password.

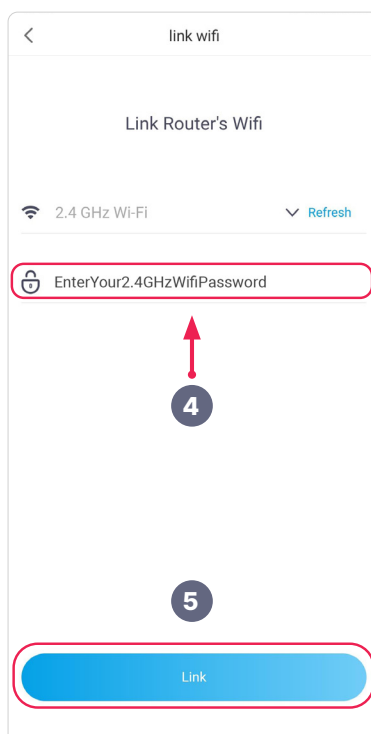
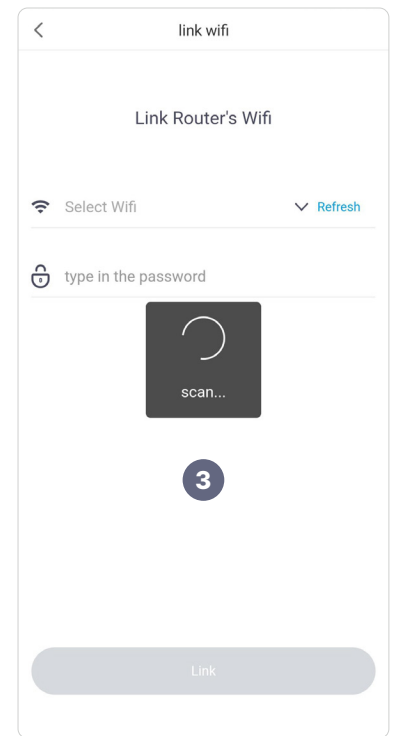
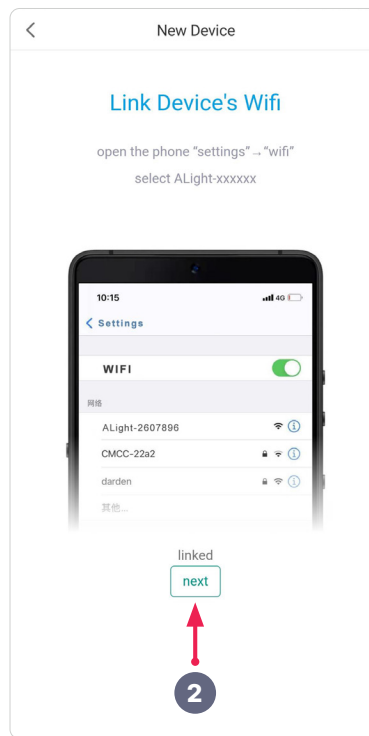
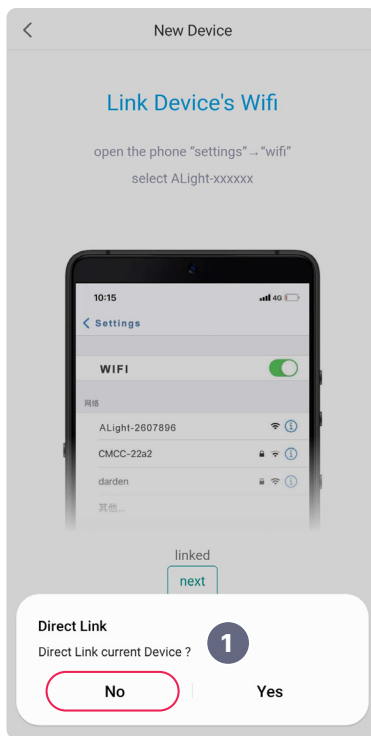

### TIP

If you don't see your light listed under the **Available networks**, press and hold the **Reset** button on your light for about 5 seconds and let go. The light will reset and go through the testing process again. Once the reset is complete, try connecting and adding the light by following the previous steps.



- Now that the light is connected, enter a **Name** for your light and a **Group** name. Note: the group name **All** is available by default in the app.
- Finally, tap the **Save** button to save your light. Your light is now ready to be controlled and configured through the app.
- After saving the light, the app will ask you to reconnect to your 2.4 GHz Wi-Fi network to control the light. If your 2.4 GHz Wi-Fi network is set as your default, this will happen automatically. If not, tap the **Set WIFI** button to open your device's Wi-Fi settings and reconnect to your network. Then return to the AIPAI app to configure your light schedule.
- Now, the light should appear on the **Devices** screen, ready for you to configure. If for any reason you need to edit or delete your light, you can do so by tapping the **Edit** button.

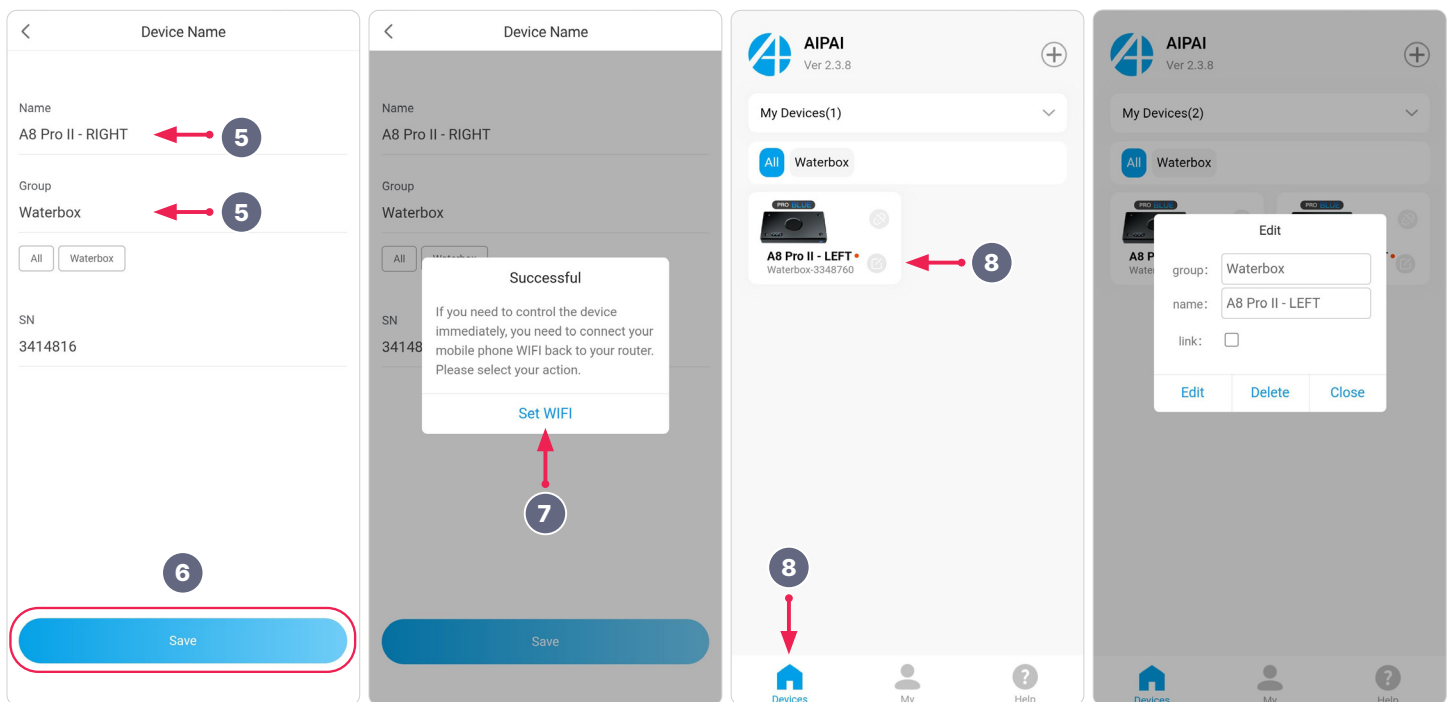

- Additionally if you multiple lights you can link them together using the link buttons.

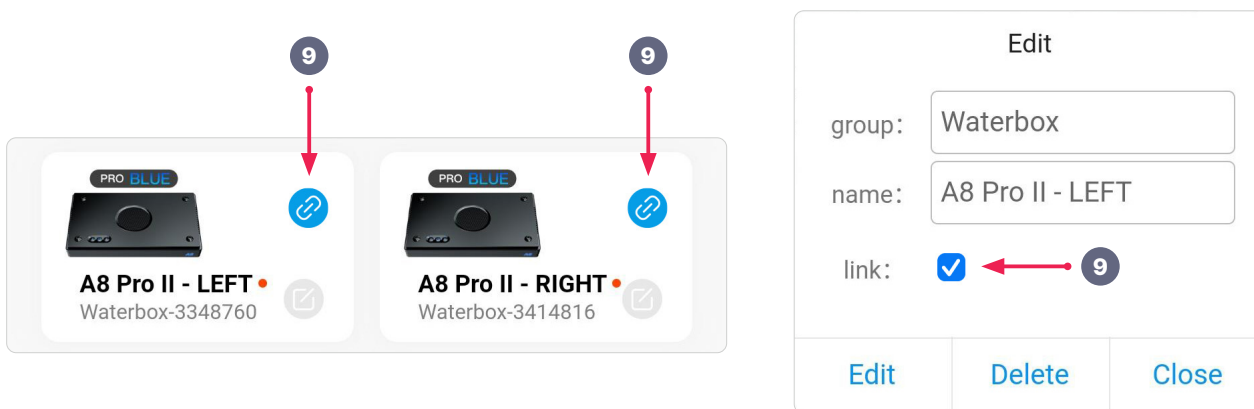

- To edit your light schedule, simply tap on the picture of the light to access its settings.

# Configuring Your Light

The following section will explain some of the functionalities of the buttons. It won't go into great depth about each button, but it should provide enough information to get you started and help you configure your light.



## SYNCING LIGHT TIME AND APP TIMEZONE:

1. When you first enter your light settings, you will be prompted to correct the time on the device. Tap the **ok** button and wait for the process to complete. Once finished, the time displayed above the light will be set correctly based on the **TimeZone** previously set in the app.
2. At that point, tap the  **Save Device** button to save and set the correct time on your light.

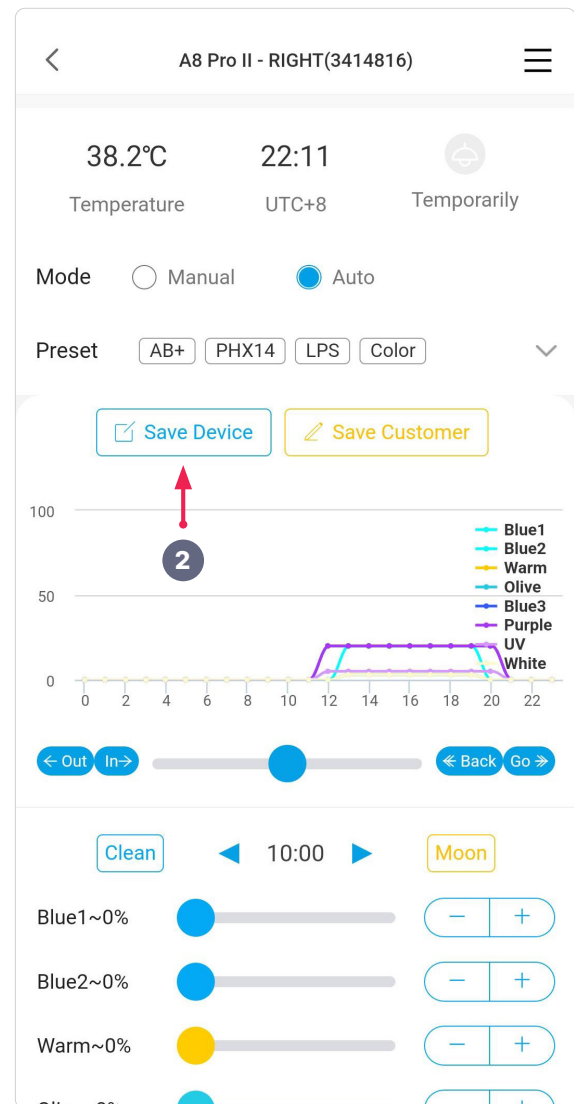
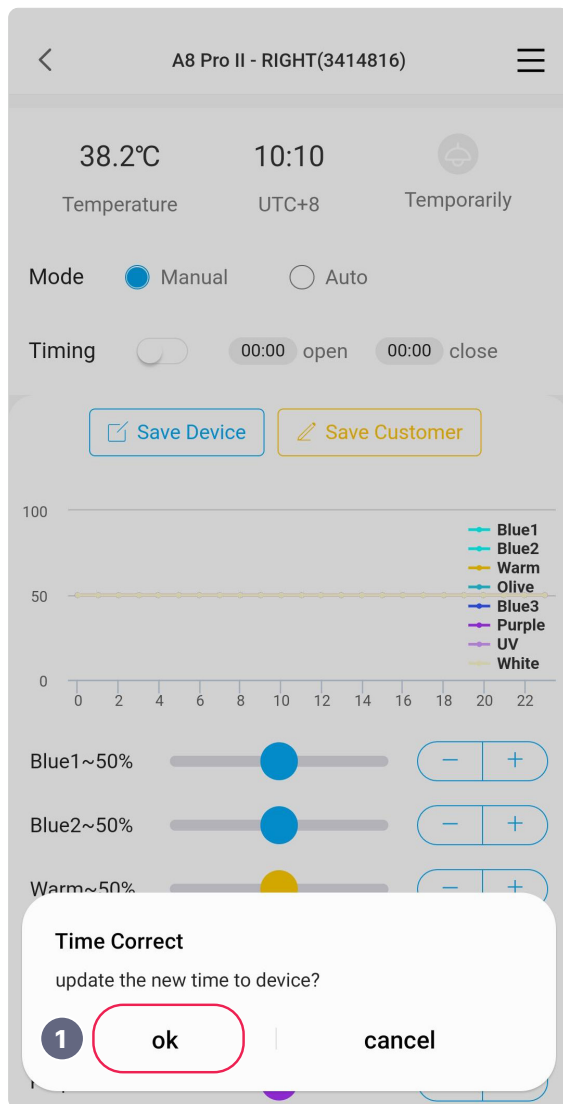
**Note:** When accessing the light settings in the future, you might be prompted to update the time on your device again. However, this may not be necessary, and you can simply tap the **cancel** button to ignore this message.



# App Button Functions

- 1 **Mode**  
 **Manual:** Set a manual configuration  
 **Auto:** Set an automatic Light Schedule
- 2 **Preset**  
 Select your Light preset. You can select from the provided presets in the app or your previously saved presets.
- 3  **Save Device**  
 Save your settings to the Light.
- 4  **Save Customer**  
 Saves your current Light Preset.
- 5    
**Moves the left side** of the graph left or right to increase or decrease the time your lights will be on or off.
- 6   
**Light Intensity Slider:** Press and hold, then drag left or right to increase or decrease the overall intensity of the schedule. The slider may not respond smoothly, so manual fine-tuning might be required using the individual light settings.
- 7    
**Moves the entire graph** left and right to change the start and end time of your light schedule.
- 8   
**WARNING:** This will delete your entire light schedule.
- 9   
 Move back and forth in one-hour intervals, allowing you to adjust the light colors and intensity for each hour.
- 10   
 No Tested.
- 11 **Blue1~0%**  
 Displays the current light color and light intensity percentage.
- 12   
**Single Light Intensity Slider:** Press and hold, then drag left or right to adjust the intensity of the selected LED color.

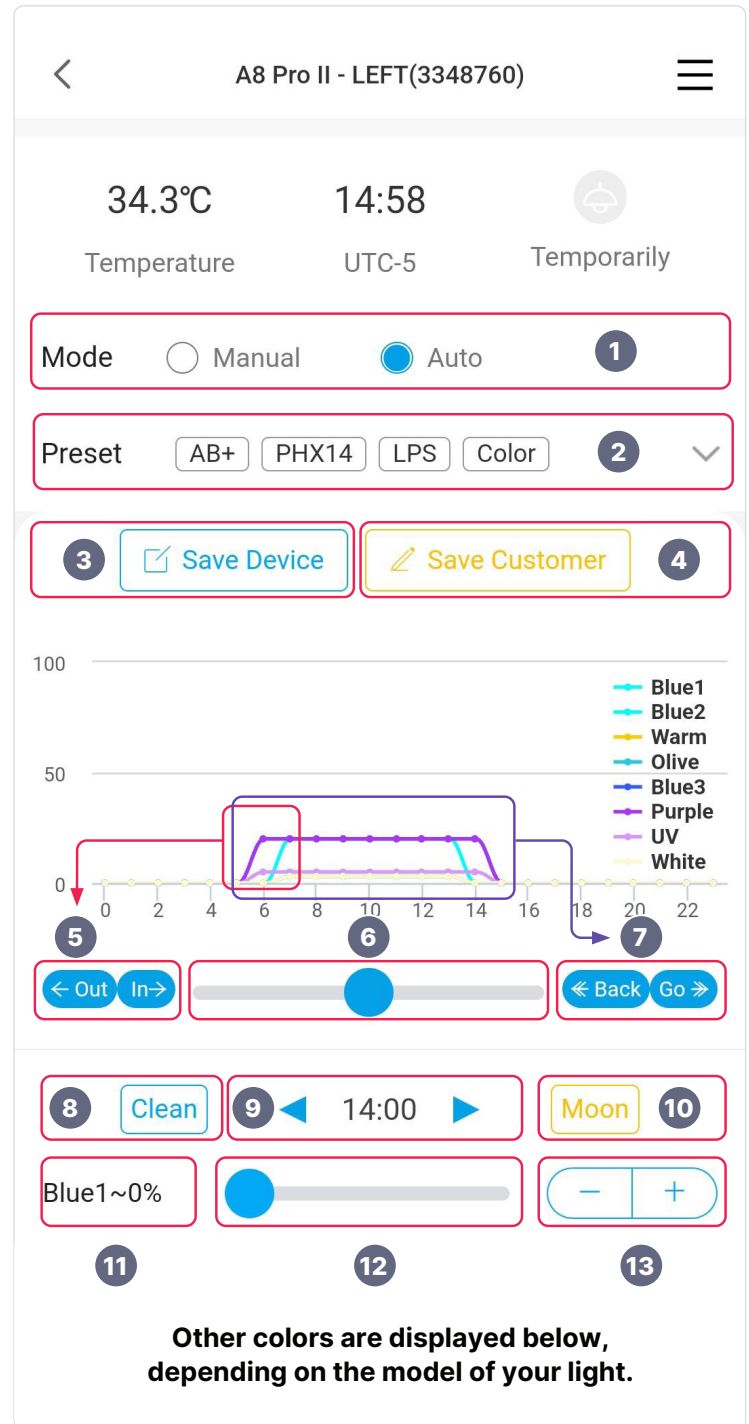

- 13    
**Plus/Minus Buttons:** Tap to increase or decrease the intensity of the selected LED color.

# Other Settings

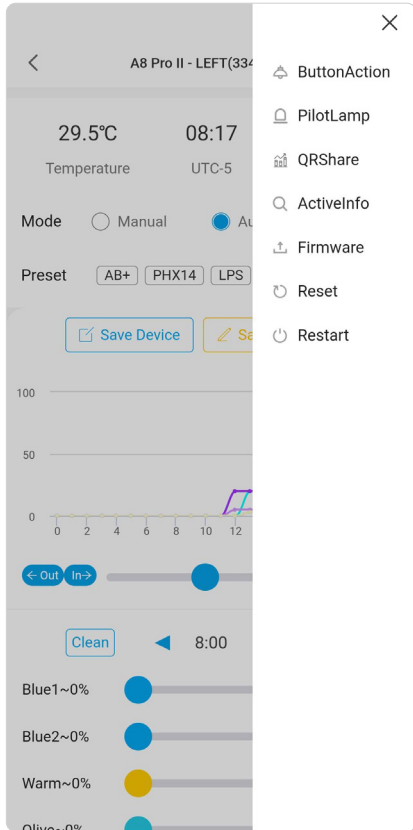

## Light Settings (The following options have not been tested)

Although the functionality of certain buttons within the **Light Settings** section appears to be self-explanatory, it is important to note that I did not have the opportunity to test them at the time this guide was created; therefore, they have not been included or explained.

 **ButtonAction**

 **PilotLamp**

 **QRShare**

 **ActiveInfo**

 **Firmware**

 **Reset**

 **Restart**

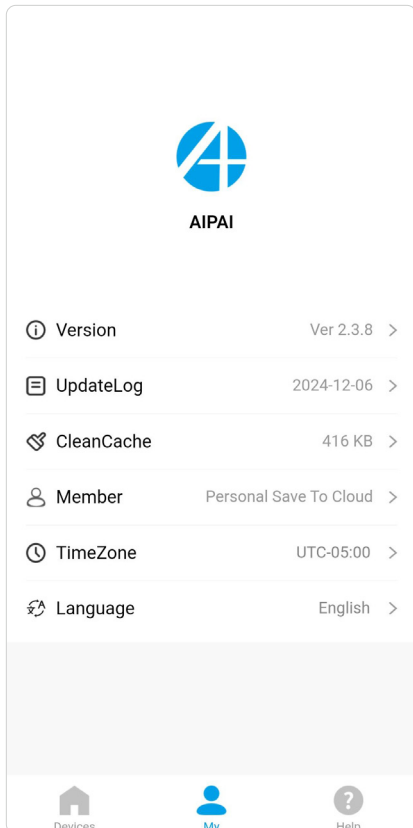

## App Settings

 **Version**  
Displays the current version of the app.

 **UpdateLog**  
Displays the date and changelog for the application update (Chinese only).

 **ClearCache**  
Clears the application cache.

 **Member**  
details are provided in the next section.

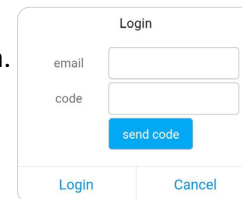

 **TimeZone**  
Provides an option to select the appropriate app time zone.

 **Language**  
Provides an option to select the app language.  
Available options: English and Chinese.

 **Help (Bottom Navigation Menu)**  
Displays a brief guide with screenshots on how to link multiple devices.



# AIPAI App

## 3.0.X Upgrade

### DISCLAIMER:

The following section is intended to address the update process from version 2.326 to version 3.0.3 or 3.0.7 (latest).

This guide has been created for **educational and informational purposes only**.

This guide involves processes that will require uninstalling the previously installed application. Users are strongly advised *not* to proceed unless they fully understand the associated risks. If you choose to proceed, you do so at your own risk.

The information provided is for general guidance only and should not be considered a substitute for professional advice or the official instructions provided by the application developer or manufacturer.

This is not a comprehensive or official guide to the AIPAI app. It is based solely on my personal experience, and I do not claim to be an expert. I accept no responsibility for any loss of data, system functionality, or other issues that may result from the use or misuse of this guide.

Use this guide at your own discretion and risk. You are solely responsible for any damage to equipment, software, or data that may occur from following the procedures described.

I am not affiliated with, endorsed by, or in any way connected to the developer, vendor, or manufacturer of the products or services mentioned in this guide. The content provided is distributed freely, without any monetary gain or commercial interest.

### COPYRIGHT AND IMAGE USE

ALL TRADEMARKS, LOGOS, PRODUCT NAMES, AND COPYRIGHTED MATERIALS MENTIONED OR USED IN THIS GUIDE ARE THE PROPERTY OF THEIR RESPECTIVE OWNERS. NO COPYRIGHT INFRINGEMENT IS INTENDED. TREATED IMAGES OF CORAL AND OTHER MATERIALS USED HEREIN ARE BASED ON WORKS CREATED BY THIRD PARTIES AND EDITED USING AN IMAGE EDITING SOFTWARE. I DO NOT CLAIM OWNERSHIP OF THESE ORIGINAL WORKS.

If you are a copyright holder and believe that your image or content has been used improperly, please contact me, and I will promptly remove it upon request.

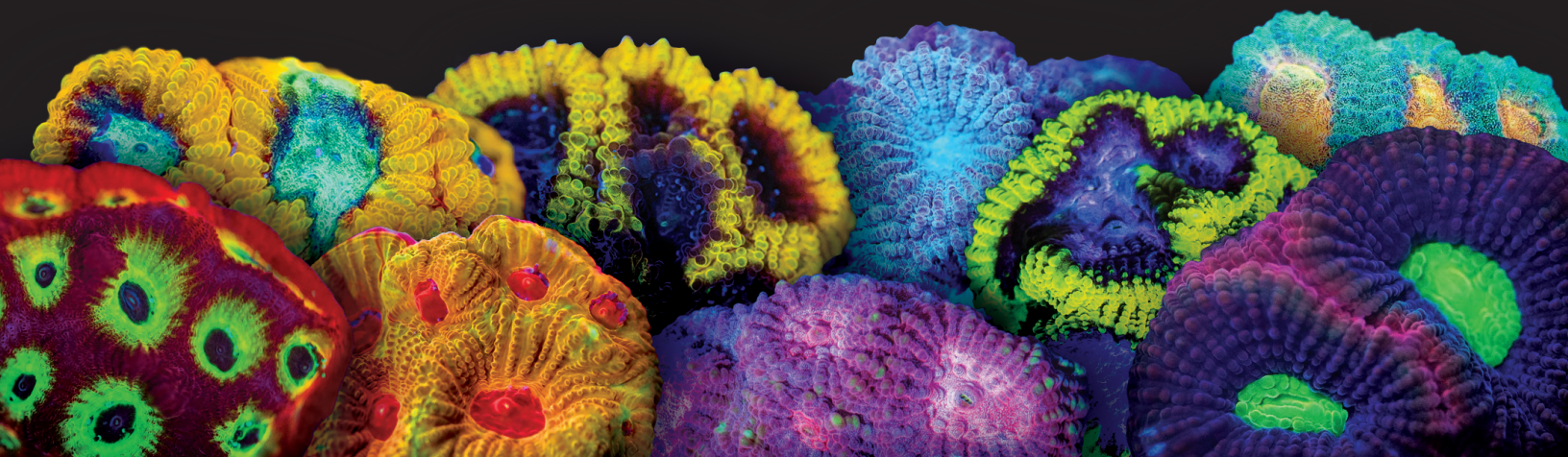

# Updating to 3.0.X

After version 2.3.26, there have been several updates to the app; however, some users reported that attempting to update directly from within the app when prompted results in an error stating that the app was not installed because the package appears to be invalid.

The following translations have been generated using an automatic translation tool.

Please note that while efforts have been made to ensure accuracy, some translations may contain errors or misinterpretations. Refer to the original text for the most reliable information.

## Version 3.0.3

**Update Info**  
Got a new version!

Latest version: 3.0.3  
Update description:  
紧急修复3.0.2版本的灯光联控bug  
Release time: 2025-09-09 09:04:06

Cancel | Update

**Update Info**  
Got a new version!

Latest version: 3.0.3  
Update description:  
Emergency fix for a lighting control bug in version 3.0.2  
Release time: 2025-09-09 09:04:06

**Error that appears while attempting to update the app to the latest version when using version 2.3.26**

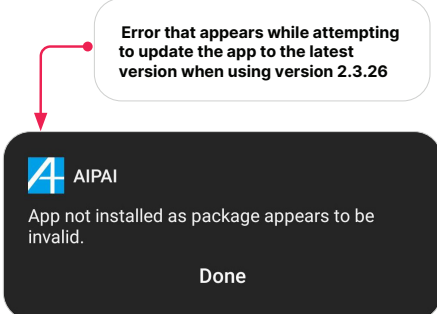

AIPAI  
App not installed as package appears to be invalid.  
Done

## Version 3.0.7 Update (Latest)

**Update Info**  
Got a new version!

Latest version: 3.0.7  
Update description:  
1. 解决灯光直连模式下, 临时点亮功能无法正常使用的问  
题  
2. 解决灯光时区设置问题  
3. 解决直连设备时不显示右上角菜单问题  
4. 英文版-设备连接失败后跳转到离线页面  
5. 添加设备时, wifi名和密码均支持特殊符号  
6. A8全系列产品, 时区设置更新  
Release time: 2025-10-09 17:31:26

Cancel | Update

**Update Info**  
Got a new version!

Latest version: 3.0.7  
Update description:  
1. Fixed an issue where the temporary brightness function could not be used normally in continuous lighting mode.  
2. Fixed a problem with the time zone setting for lighting.  
3. Fixed an issue where the upper-right menu was not displayed when the device was connected directly.  
4. English version – Fixed an issue where the app redirected to the offline page after a failed connection attempt.  
5. When adding a device, both Wi-Fi names and passwords now support special characters.  
6. Time zone settings updated for all A8 series products.  
Release time: 2025-10-09 17:31:26



## AIPAI App download link

You can use the following link to download the latest version of the app. This is the same link provided in the user manual included in the box with your lights.

Alternatively, you can scan the QR code to download the app. Once there, select the Android version to begin the download.

<http://www.doseen.com/ahome/download.html>

Once the download is complete, please carefully follow the subsequent steps to update your application from version 2.3.26 to version 3.0.7.

## ! IMPORTANT

The following steps are critical to ensure that the lights do not need to be reconnected and reconfigured after uninstalling the outdated version of the app from your phone or device.

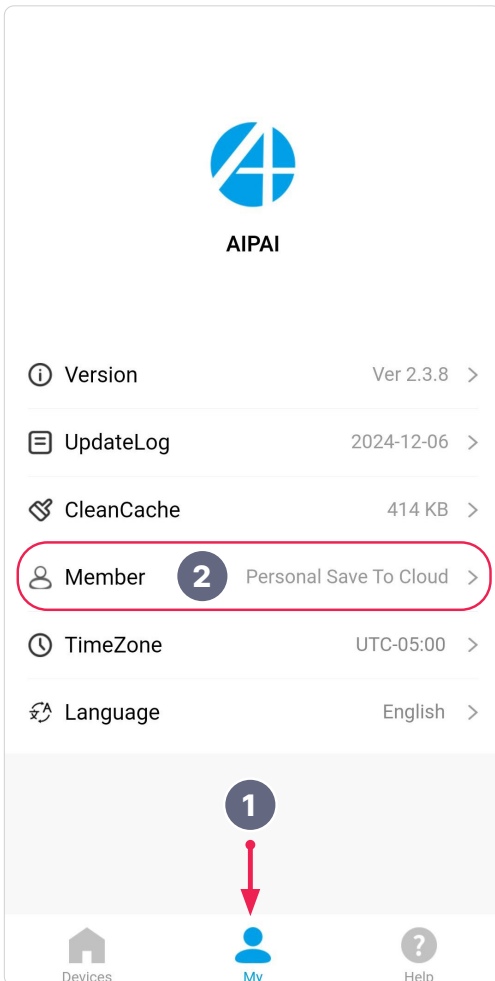

### LOGIN to your Cloud Account to save and backup your current light(s) configuration data:

1. In your app got to **My** in the bottom menu.
2. Tap in the option **Personal Save to Cloud option**.
3. In the **Login** modal enter your email in the **email** input field. This email will be used to create an account that stores the data and configuration of all lights or other devices added to the AIPAI app on a remote Cloud Account.
4. Tap the button **send code**.
5. After tapping the **send code** button, a verification code will be sent to the email address entered in the **email** input field. Please check your email inbox, locate the email, copy the code, and enter it into the verification **code** input field.
6. Finally, tap the **Login** button to login into your account.
7. After tapping the Login button, a confirmation message will appear in the app indicating that you have successfully logged in.

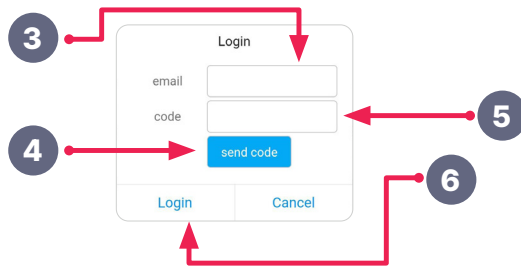

### SAVE AND BACKUP your current light(s) configuration data:

1. After successfully logging in, the text will change from **Personal Save To Cloud** and display a partially masked version of your email address, followed by the word **[manage]**.
2. Tap the partially masked email followed by the **[manage]** option to open the **Data Detail** dialog.
3. Then, tap the **Upload** button to save your lighting data and settings to your account.

After tapping the **Upload** button, you should receive a confirmation message stating **Successful**, indicating that your data and settings have been saved to your account.

You may now close the app and proceed to the next steps.

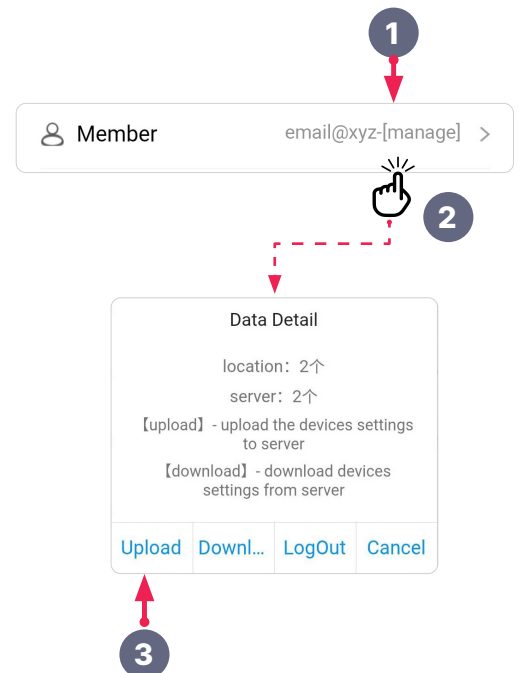

## ! IMPORTANT

If you attempted to update the app to the latest version (3.0.7) from within the app itself and encountered issues, the only available solution is to uninstall the current version and perform a fresh installation of the new version.

If you do not feel comfortable performing this action, you **SHOULD STOP HERE** and not proceed further.

Now that your light settings and configuration have been backed up to your Cloud Account, we can proceed to uninstall the current version of the app and prepare to install the new version.

### Uninstall old AIPAI App version

1. On your Android phone or device, go to **Settings** and then tap on the **Apps** option.
2. In the Apps list, locate **AIPAI** and uninstall it.
3. Now, locate the previously downloaded **version 3.0.7** of the AIPAI app in your phone or device.
4. Follow the same **Installation Steps** at the beginning of the guide from **page 1 through page 3** to install the new version of the app.
5. Once the installation steps are completed, your new version of the app should be ready for use.

**Please note:** The installation steps are the same as those used for the previous version of the app and involve the same process. If you have already enabled **Install unknown apps** in your phone, you may not need to do so again.

However, if you encounter issues installing the new version, please ensure that you follow all **Installation Steps** guide carefully.

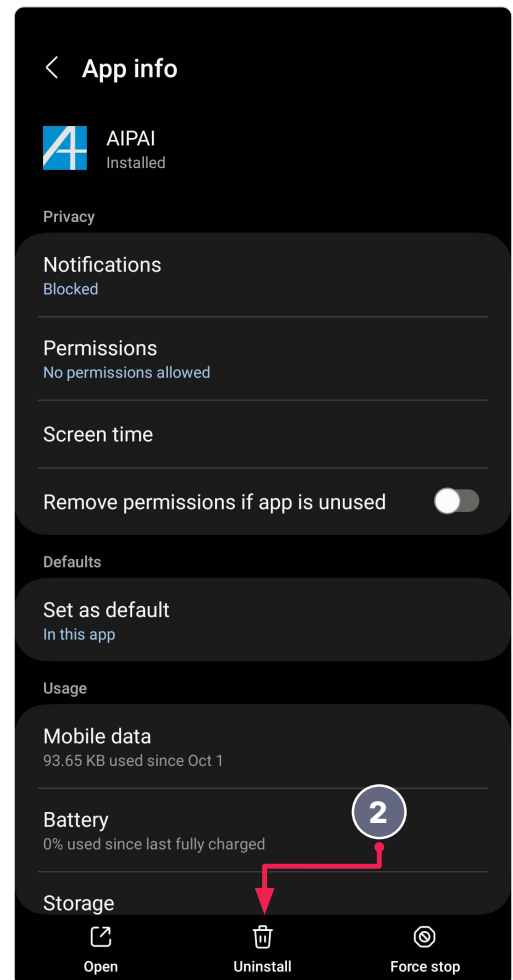

Now that the new version of AIPA is installed, we can proceed to restore the lighting parameters using the previously saved data from our cloud account, without the hassle of reconnecting lights or other devices.

Once you open the newly installed AIPA app (version 3.0.7), you will notice that the bottom navigation menu has changed, and some options have been relocated to different a different menu. Before proceeding, we need to restore the configuration of our lights and devices using the data previously saved to our Cloud Account. To do so, please follow the next steps.

### Restore the light(s) configuration

1. In the app, tap the **My** , now located on the right side of the bottom navigation menu.
2. Follow the same steps to log back into your Cloud Account as outlined on **page 13** to retrieve your previously saved light settings and configuration parameters.
3. Once you have logged in, tap the partially masked email address followed by the word **[manage]** to open the **Data Detail** dialog.
4. Finally, tap the **Download** option to restore your light configuration and settings.

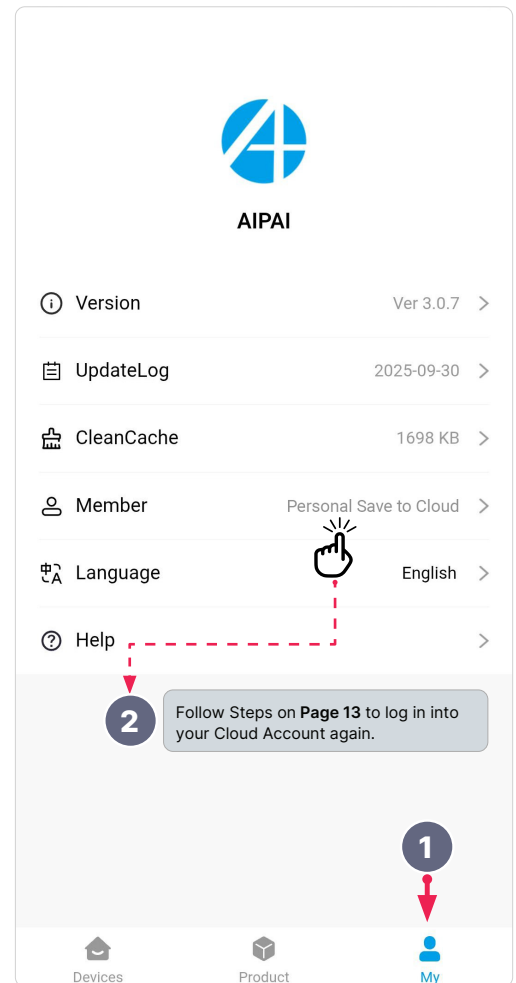
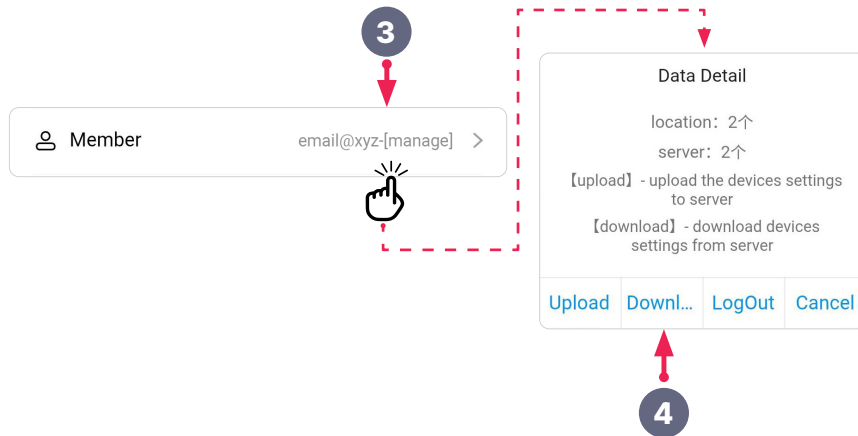





After you tap the **Download** button, your light(s) settings and configuration should be successfully restored, and there should be no need to reconnect or re-link the devices in the app.

However, please note that the **Time Zone** and **Time** settings must be reconfigured manually on each device.

As of now, these are the only two parameters that require reconfiguration after upgrading to the new app and restoring your light(s) or device(s) configuration.

To do so, please follow the steps in the next page.

## Setting the time and correct time zone in the light(s) or device(s)

1. In the app, tap the  **Devices** option, located on the left side of the bottom navigation menu.
2. Then, tap on a light or device to configure the correct time and time zone.
3. Tap in the  Hamburger Menu icon at the top right corner.
4. Select  **TimeZoneSet** from the list.
5. In the **Set** dialog, tap the time zone field located next to the **timeZone** label to open the time zone list.
6. From the time zone list select your correct time zone. To determine your correct UTC time zone in the U.S., visit <https://www.time.gov>.
7. Then, tap the **Save** button in the **Set** dialog and wait for the **Time Zone** and **Time** to update on your light or device.
8. Finally tap on the  **Save Device** button to save corrected the time and time zone to light or device.
9. Once saved, a **Successful** message will appear on the screen, indicating that the configuration is complete.

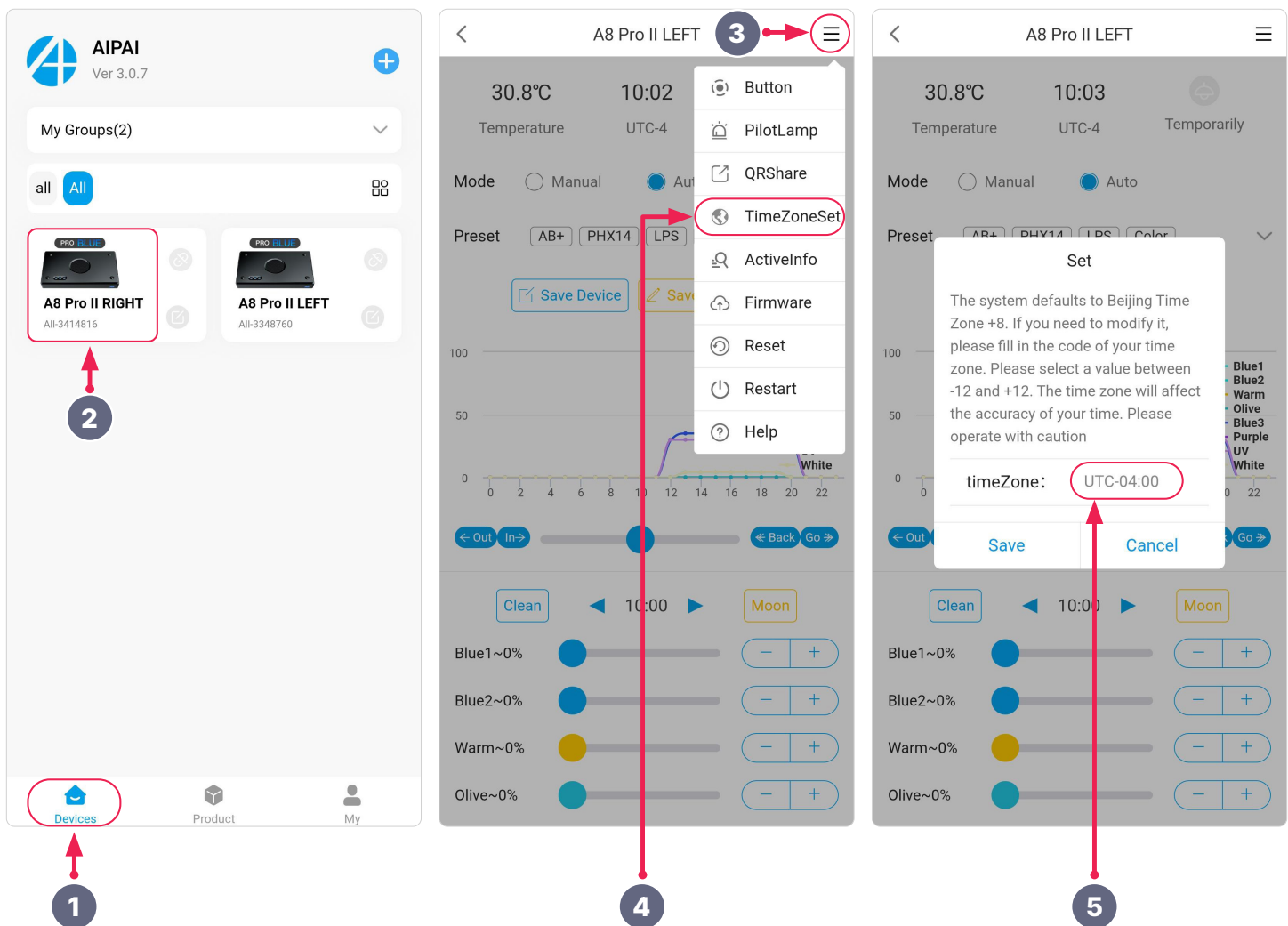

Graphic instructions continue on the next page 

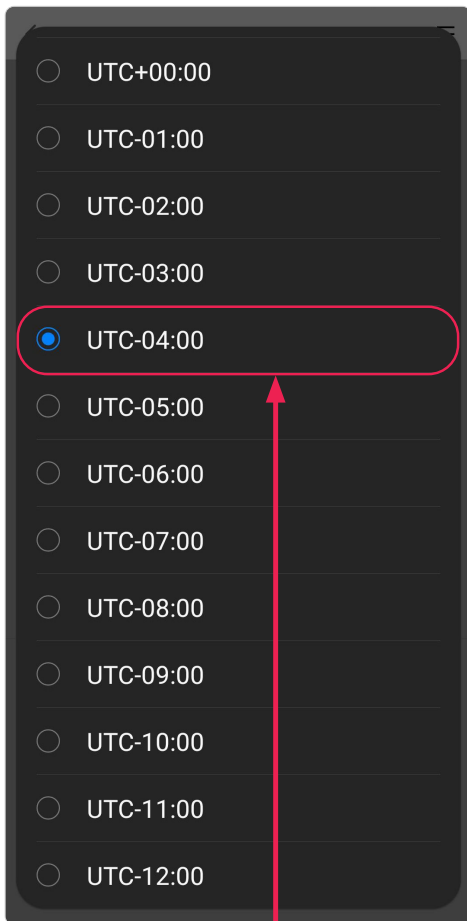

6

Select the appropriate time zone based on your current location.

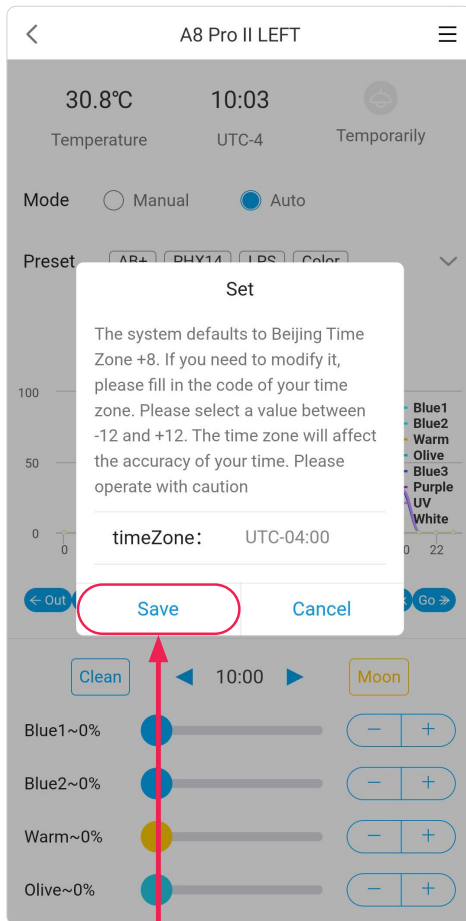

7

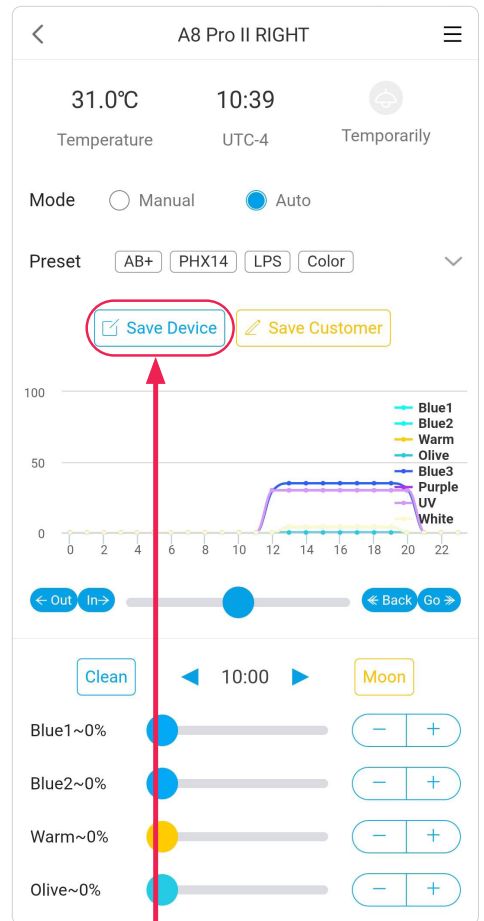

8

### ! IMPORTANT

Please note that these steps must be performed for each light individually, as the time and time zone settings are now managed per device and are no longer a global setting.

Once all the previous steps have been completed for each light(s) or device(s), your light(s) schedule and/or devices configuration should be fully set.

The new version (3.0.7) of the app includes a Help option under the My settings, which provides guides for A8 lights as well as other devices. These resources may be useful during the installation or connection process.

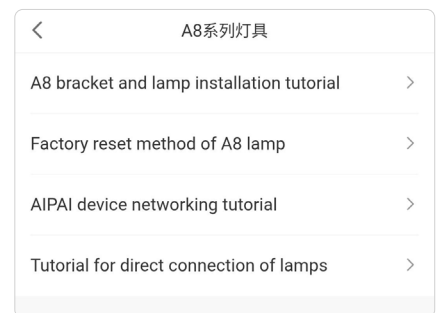
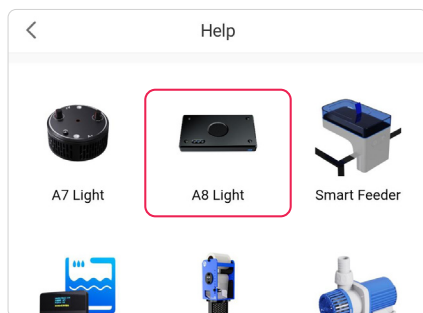
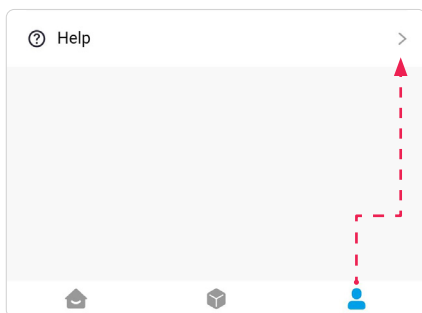

# Thanks

I hope this guide—though not complete or comprehensive—offers some helpful direction in connecting and setting up your A8 Light. Enjoy, and happy reefing!

